



End Mills for general purpose and exotic materials

EPL-HP-SERIES

Volume 4



KEY FEATURES: EPL-HP-4FL/5FL

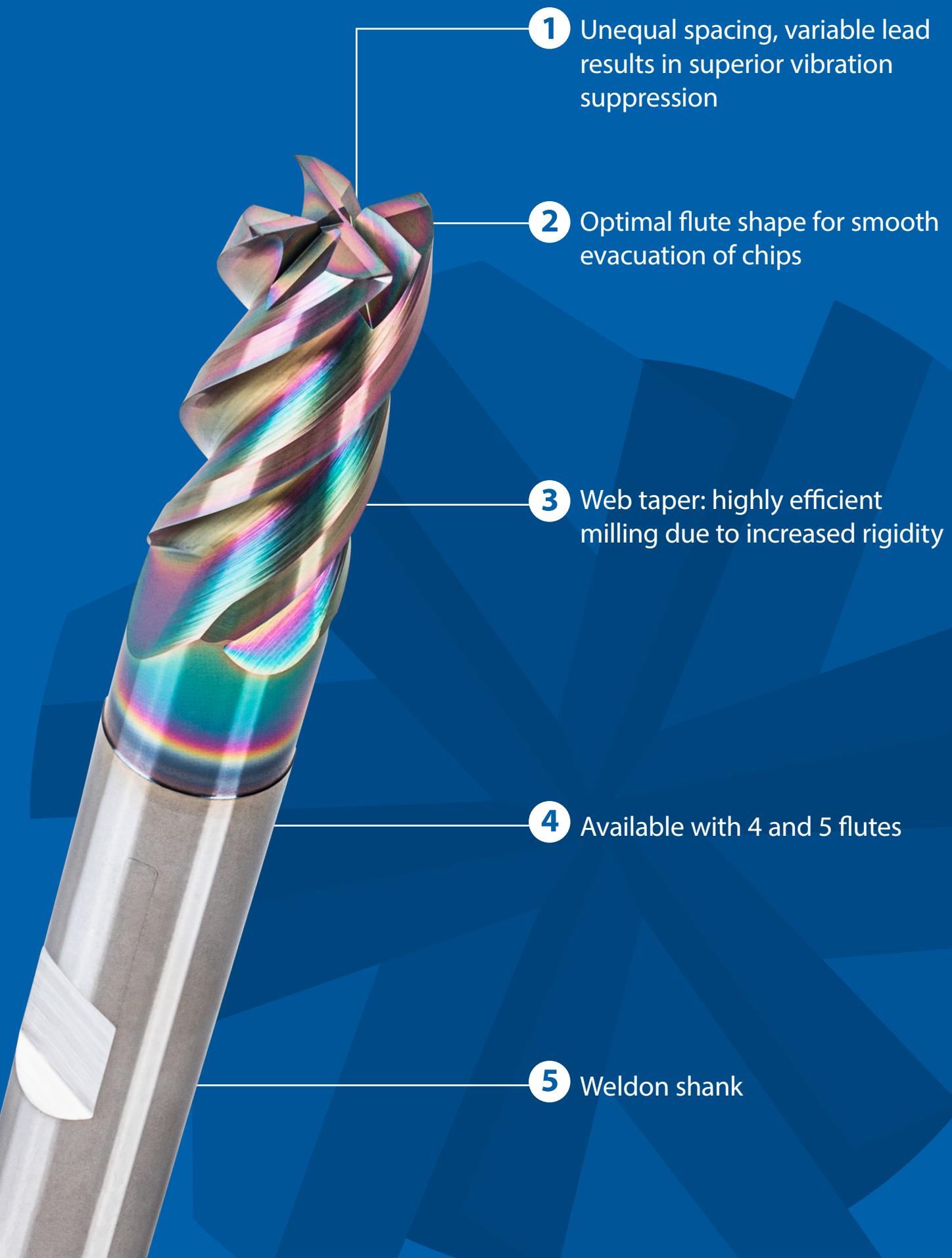

1 Unequal spacing, variable lead results in superior vibration suppression

2 Optimal flute shape for smooth evacuation of chips

3 Web taper: highly efficient milling due to increased rigidity

4 Available with 4 and 5 flutes

5 Weldon shank

EPL-HP-4FL

Milling | Solid carbide

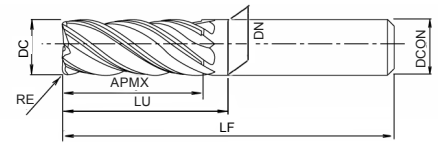
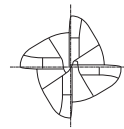
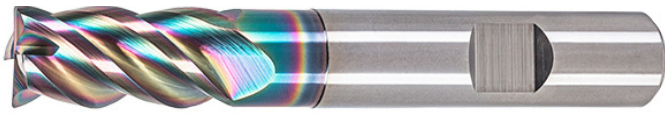

- Carbide end mill with EgiAs coating
- For general applications and exotic materials
- 4 flutes, variable helix and unequal spacing, corner radius
- Weldon shank

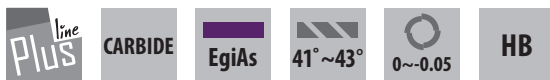

EDP	ZEFP	DC	RE	LU	LF	APMX	DCON	DN
EP01930399	4	3	-	11	57	8	6	-
EP01930300	4	3	0,25	11	57	8	6	-
EP01930301	4	3	0,5	11	57	8	6	-
EP01930499	4	4	-	13	57	11	6	-
EP01930400	4	4	0,25	13	57	11	6	-
EP01930401	4	4	0,5	13	57	11	6	-
EP01930402	4	4	1	13	57	11	6	-
EP01930599	4	5	-	15	57	13	6	-
EP01930500	4	5	0,25	15	57	13	6	-
EP01930501	4	5	0,5	15	57	13	6	-
EP01930502	4	5	1	15	57	13	6	-
EP01930699	4	6	-	20	57	13	6	5,8
EP01930600	4	6	0,25	20	57	13	6	5,8
EP01930601	4	6	0,5	20	57	13	6	5,8
EP01930602	4	6	1	20	57	13	6	5,8
EP01930603	4	6	1,5	20	57	13	6	5,8
EP01930899	4	8	-	25	63	19	8	7,8
EP01930800	4	8	0,25	25	63	19	8	7,8
EP01930801	4	8	0,5	25	63	19	8	7,8
EP01930802	4	8	1	25	63	19	8	7,8
EP01930803	4	8	1,5	25	63	19	8	7,8
EP01931099	4	10	-	30	72	22	10	9,8
EP01931000	4	10	0,25	30	72	22	10	9,8
EP01931001	4	10	0,5	30	72	22	10	9,8
EP01931002	4	10	1	30	72	22	10	9,8
EP01931003	4	10	1,5	30	72	22	10	9,8
EP01931004	4	10	2	30	72	22	10	9,8
EP01931006	4	10	3	30	72	22	10	9,8
EP01931299	4	12	-	38	83	26	12	11,8
EP01931200	4	12	0,25	38	83	26	12	11,8
EP01931201	4	12	0,5	38	83	26	12	11,8
EP01931202	4	12	1	38	83	26	12	11,8
EP01931204	4	12	2	38	83	26	12	11,8
EP01931206	4	12	3	38	83	26	12	11,8
EP01931207	4	12	4	38	83	26	12	11,8
EP01931499	4	14	-	44	92	32	16	15,8
EP01931400	4	14	0,25	44	92	32	16	15,8
EP01931402	4	14	1	44	92	32	16	15,8
EP01931699	4	16	-	44	92	32	16	15,8
EP01931600	4	16	0,25	44	92	32	16	15,8
EP01931601	4	16	0,5	44	92	32	16	15,8
EP01931602	4	16	1	44	92	32	16	15,8
EP01931604	4	16	2	44	92	32	16	15,8
EP01931606	4	16	3	44	92	32	16	15,8
EP01931607	4	16	4	44	92	32	16	15,8
EP01932099	4	20	-	54	104	38	20	19,8

Milling | Solid carbide



EPL-HP-5FL

Milling | Solid carbide

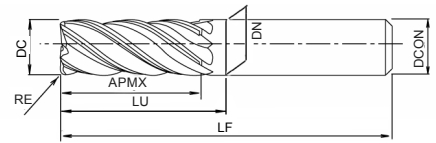
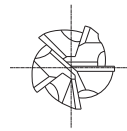
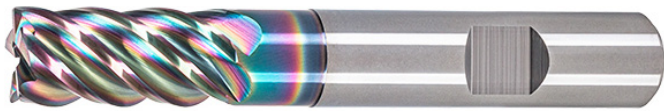

- Carbide end mill with EgiAs coating
- For general applications and exotic materials
- 5 flutes, variable helix and unequal spacing, corner radius
- Weldon shank

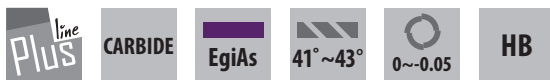

EDP	ZEFP	DC	RE	LU	LF	APMX	DCON	DN
EP01940699	5	6	-	20	57	13	6	5,8
EP01940600	5	6	0,25	20	57	13	6	5,8
EP01940601	5	6	0,5	20	57	13	6	5,8
EP01940602	5	6	1	20	57	13	6	5,8
EP01940899	5	8	-	25	63	19	8	7,8
EP01940800	5	8	0,25	25	63	19	8	7,8
EP01940801	5	8	0,5	25	63	19	8	7,8
EP01940802	5	8	1	25	63	19	8	7,8
EP01940803	5	8	1,5	25	63	19	8	7,8
EP01941099	5	10	-	30	72	22	10	9,8
EP01941000	5	10	0,25	30	72	22	10	9,8
EP01941001	5	10	0,5	30	72	22	10	9,8
EP01941002	5	10	1	30	72	22	10	9,8
EP01941003	5	10	1,5	30	72	22	10	9,8
EP01941004	5	10	2	30	72	22	10	9,8
EP01941006	5	10	3	30	72	22	10	9,8
EP01941299	5	12	-	38	83	26	12	11,8
EP01941200	5	12	0,25	38	83	26	12	11,8
EP01941201	5	12	0,5	38	83	26	12	11,8
EP01941202	5	12	1	38	83	26	12	11,8
EP01941204	5	12	2	38	83	26	12	11,8
EP01941206	5	12	3	38	83	26	12	11,8
EP01941207	5	12	4	38	83	26	12	11,8
EP01941699	5	16	-	44	92	32	16	15,8
EP01941600	5	16	0,25	44	92	32	16	15,8
EP01941601	5	16	0,5	44	92	32	16	15,8
EP01941602	5	16	1	44	92	32	16	15,8
EP01941604	5	16	2	44	92	32	16	15,8
EP01941606	5	16	3	44	92	32	16	15,8
EP01941607	5	16	4	44	92	32	16	15,8
EP01942099	5	20	-	54	104	38	20	19,8
EP01942000	5	20	0,25	54	104	38	20	19,8
EP01942001	5	20	0,5	54	104	38	20	19,8
EP01942002	5	20	1	54	104	38	20	19,8
EP01942004	5	20	2	54	104	38	20	19,8
EP01942006	5	20	3	54	104	38	20	19,8
EP01942007	5	20	4	54	104	38	20	19,8

Milling | Solid carbide



CUTTING CONDITIONS

Milling | Endmills | Cutting conditions

EPL-HP-4FL

Slotting

Vc		Steels St-52 • C45 • GG-25			Hardened steels ~35 HRC 42CrMo4			Hardened steels ~45 HRC 1.2379			Stainless steel 1.4301			Titanium Ti6AlV4		
Vc		120 m/min			120 m/min			70 m/min			60 m/min			50 m/min		
Ø	Z	S (min ⁻¹)	F (mm/min)	fz (mm)	S (min ⁻¹)	F (mm/min)	fz (mm)	S (min ⁻¹)	F (mm/min)	fz (mm)	S (min ⁻¹)	F (mm/min)	fz (mm)	S (min ⁻¹)	F (mm/min)	fz (mm)
3	4	12.739	1.325	0,026	12.739	1.325	0,026	7.431	773	0,026	6.369	535	0,018	5.308	382	0,018
4	4	9.549	1.146	0,030	9.549	1.146	0,030	5.570	668	0,030	4.775	382	0,020	3.979	318	0,020
5	4	7.639	1.146	0,038	7.639	1.146	0,038	4.456	668	0,038	3.820	382	0,025	3.183	318	0,025
6	4	6.366	1.146	0,045	6.366	1.146	0,045	3.714	668	0,045	3.183	382	0,030	2.653	318	0,030
8	4	4.775	1.146	0,060	4.775	1.146	0,060	2.785	668	0,060	2.387	382	0,040	1.989	318	0,040
10	4	3.820	1.146	0,075	3.820	1.146	0,075	2.228	668	0,075	1.910	382	0,050	1.592	318	0,050
12	4	3.183	1.146	0,090	3.183	1.146	0,090	1.857	668	0,090	1.592	382	0,060	1.326	318	0,060
14	4	2.728	1.146	0,105	2.728	1.146	0,105	1.592	668	0,105	1.364	382	0,070	1.137	318	0,070
16	4	2.387	1.146	0,120	2.387	1.146	0,120	1.393	668	0,120	1.194	382	0,080	995	318	0,080
20	4	1.910	1.146	0,150	1.910	1.146	0,150	1.114	668	0,150	955	382	0,100	796	318	0,100

ap x d F(fz) correction		ap	Fakt.
		0,5	1,0
		1,0	0,7
		1,5	0,5
		2,0	0,3

The above stated application data are as per **RED** marked parameters.

EPL-HP-4FL

Side milling

Vc		Steels St-52 • C45 • GG-25			Hardened steels ~35 HRC 42CrMo4			Hardened steels ~45 HRC 1.2379			Stainless steel 1.4301			Titanium Ti6AlV4		
Vc		140 m/min			140 m/min			80 m/min			70 m/min			60 m/min		
Ø	Z	S (min ⁻¹)	F (mm/min)	fz (mm)	S (min ⁻¹)	F (mm/min)	fz (mm)	S (min ⁻¹)	F (mm/min)	fz (mm)	S (min ⁻¹)	F (mm/min)	fz (mm)	S (min ⁻¹)	F (mm/min)	fz (mm)
3	4	14.862	3.567	0,060	14.862	3.567	0,060	8.493	2.038	0,060	7.431	1.019	0,030	6.369	764	0,030
4	4	11.141	3.565	0,080	11.141	3.565	0,080	6.366	2.037	0,080	5.570	891	0,040	4.775	764	0,040
5	4	8.913	3.565	0,100	8.913	3.565	0,100	5.093	2.037	0,100	4.456	891	0,050	3.820	764	0,050
6	4	7.427	3.565	0,120	7.427	3.565	0,120	4.244	2.037	0,120	3.714	891	0,060	3.183	764	0,060
8	4	5.570	3.565	0,160	5.570	3.565	0,160	3.183	2.037	0,160	2.785	891	0,080	2.387	764	0,080
10	4	4.456	3.565	0,200	4.456	3.565	0,200	2.546	2.037	0,200	2.228	891	0,100	1.910	764	0,100
12	4	3.714	3.565	0,240	3.714	3.565	0,240	2.122	2.037	0,240	1.857	891	0,120	1.592	764	0,120
14	4	3.183	3.565	0,280	3.183	3.565	0,280	1.819	2.037	0,280	1.592	891	0,140	1.364	764	0,140
16	4	2.785	3.565	0,320	2.785	3.565	0,320	1.592	2.037	0,320	1.393	891	0,160	1.194	764	0,160
20	4	2.228	3.565	0,400	2.228	3.565	0,400	1.273	2.037	0,400	1.114	891	0,200	955	764	0,200

ap x d F(fz) correction		ap	Fakt.
		0,5	1,3
		1,0	1,2
		1,5	1,0
		2,0	0,8

ap	Fakt.		
		0,5	1,2
		1,0	1,0
		1,5	0,7
		2,0	0,5

The above stated application data are as per **RED** marked parameters.

Milling | Endmills

Cutting conditions

CUTTING CONDITIONS

Milling | Endmills | Cutting conditions

EPL-HP-5FL

Slotting

Vc		Steels St-52 • C45 • GG-25			Hardened steels ~35 HRC 42CrMo4			Hardened steels ~45 HRC 1.2379			Stainless steel 1.4301			Titanium Ti6AlV4		
Ø	Z	S (min ⁻¹)	F (mm/min)	fz (mm)	S (min ⁻¹)	F (mm/min)	fz (mm)	S (min ⁻¹)	F (mm/min)	fz (mm)	S (min ⁻¹)	F (mm/min)	fz (mm)	S (min ⁻¹)	F (mm/min)	fz (mm)
6	5	6.369	1.433	0,045	6.369	1.433	0,045	3.715	836	0,045	3.185	650	0,035	2.654	464	0,035
8	5	4.775	1.432	0,060	4.775	1.432	0,060	2.785	836	0,060	2.387	477	0,040	1.989	398	0,040
10	5	3.820	1.432	0,075	3.820	1.432	0,075	2.228	836	0,075	1.910	477	0,050	1.592	398	0,050
12	5	3.183	1.432	0,090	3.183	1.432	0,090	1.857	836	0,090	1.592	477	0,060	1.326	398	0,060
16	5	2.387	1.432	0,120	2.387	1.432	0,120	1.393	836	0,120	1.194	477	0,080	995	398	0,080
20	5	1.910	1.432	0,150	1.910	1.432	0,150	1.114	836	0,150	955	477	0,100	796	398	0,100

ap x d	F(fz) correction	ap	Fakt.
		0,5	1,0
		1,0	0,7
		1,5	0,5
		2,0	0,3

The above stated application data are as per **RED** marked parameters.

EPL-HP-5FL

Side milling

Vc		Steels St-52 • C45 • GG-25			Hardened steels ~35 HRC 42CrMo4			Hardened steels ~45 HRC 1.2379			Stainless steel 1.4301			Titanium Ti6AlV4		
Ø	Z	S (min ⁻¹)	F (mm/min)	fz (mm)	S (min ⁻¹)	F (mm/min)	fz (mm)	S (min ⁻¹)	F (mm/min)	fz (mm)	S (min ⁻¹)	F (mm/min)	fz (mm)	S (min ⁻¹)	F (mm/min)	fz (mm)
6	5	7.431	4.459	0,120	7.431	4.459	0,120	4.246	2.548	0,120	3.715	1.274	0,060	3.185	955	0,060
8	5	5.570	4.456	0,160	5.570	4.456	0,160	3.183	2.546	0,160	2.785	1.114	0,080	2.387	955	0,080
10	5	4.456	4.456	0,200	4.456	4.456	0,200	2.546	2.546	0,200	2.228	1.114	0,100	1.910	955	0,100
12	5	3.714	4.456	0,240	3.714	4.456	0,240	2.122	2.546	0,240	1.857	1.114	0,120	1.592	955	0,120
16	5	2.785	4.456	0,320	2.785	4.456	0,320	1.592	2.546	0,320	1.393	1.114	0,160	1.194	955	0,160
20	5	2.228	4.456	0,400	2.228	4.456	0,400	1.273	2.546	0,400	1.114	1.114	0,200	955	955	0,200

ap x d	F(fz) correction	ap	Fakt.
		0,5	1,3
		1	1,2
		1,5	1,0
		2	0,8

ap	Fakt.
0,5	1,2
1,0	1,0
1,5	0,7
2,0	0,5

The above stated application data are as per **RED** marked parameters.

ALSO AVAILABLE FROM PLUS-LINE

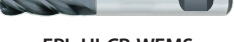
Type	Coating	Material	Material													Range							
			Hardened Steel					SUS	GG														
			~40 HRC	~45 HRC	~55 HRC	~60 HRC	~65 HRC	~35 HRC	~350 HB	Cu	Al	Graphite	Ti	HRS	Plast.		CFRP						
 EPL-ETS	TiAlN	CARBIDE	⊙	⊙	○				⊙	⊙	○	○					⊙	⊙					4 ~ 16
 EPL-SB-EBD	TiAlN	CARBIDE	⊙	⊙	○	○			○	⊙	○	○					○	○					R0,5 ~ R10
 EPL-SB-LN-EBD	TiAlN	CARBIDE	⊙	⊙	○	○			○	⊙	○	○					○	○					R0,5 ~ R10
 EPL-SB-EBM	TiAlN	CARBIDE	⊙	⊙	○	○			○	⊙	○	○					○	○					R2 ~ R6
 EPL-HI-EMS	TiAlN	CARBIDE	⊙	⊙	⊙	○			⊙	⊙	○	○					⊙	⊙					4 ~ 20
 EPL-HI-WEMS	TiAlN	CARBIDE	⊙	⊙	⊙	○			⊙	⊙	○	○					⊙	⊙					4 ~ 20
 EPL-HI-CR-EMS	TiAlN	CARBIDE	⊙	⊙	⊙	○			⊙	⊙	○	○					⊙	⊙					4 ~ 16
 EPL-HI-CR-WEMS	TiAlN	CARBIDE	⊙	⊙	⊙	○			⊙	⊙	○	○					⊙	⊙					4 ~ 20
 EPL-WRESF	TiAlN	CARBIDE	⊙	⊙	⊙				○	○	○	○											4 ~ 25
 EPL-PC-EBD	TiAlN	CARBIDE	⊙	⊙	○	○			⊙	⊙	⊙	○					○	○					R0,5 ~ R4
 EPL-PC-EBD-DIA	DIA	CARBIDE	⊙	⊙					⊙	⊙	⊙	○					○	○					R0,5 ~ R4
 EPL-LN-EBD	TiAlN	CARBIDE	⊙	⊙	○	○			⊙	⊙	⊙	○					○	○					R0,15 ~ R3
 EPL-CPR	TiAlN	CARBIDE	⊙	⊙	⊙	⊙	○		○	○							○	○					2 ~ 8
 EPL-CPR-DIA	DIA	CARBIDE	⊙	⊙	⊙	⊙			⊙														4 ~ 8
 EPL-HP-4FL	EgiAs	CARBIDE	⊙	⊙					⊙	⊙	○	○					⊙						3 ~ 20
 EPL-HP-5FL	EgiAs	CARBIDE	⊙	⊙					⊙	⊙	○	○					⊙						6 ~ 20





www.osgeurope.com



SWEDEN

Branch office of OSG SCANDINAVIA
Singelgatan 7
212 28 Malmö
Sweden
Tel: +46 40 41 22 55
osg@osg-scandinavia.com

OSG SCANDINAVIA

(For Scandinavian countries)
Langebjergvaenget 16
4000 Roskilde
Denmark
Tel: +45 46 75 65 55
osg@osg-scandinavia.com

OSG NETHERLANDS

Bedrijfsweg 5
3481 MG Harmelen
The Netherlands
Tel: +31 348 44 2764
info@osg-nl.com

OSG UK

Kelsey Close, Attleborough Fields Ind Est,
CV11 6RS, Nuneaton
United Kingdom
Tel: +44 (0) 1827 720 013
uk_sales@osg-uk.com

OSG EUROPE LOGISTICS

Avenue Lavoisier 1
B-1300 Z.I. Wavre - Nord
Belgium
Tel: +32 10 23 05 07
info@osgeurope.com

OSG BELUX

Avenue Lavoisier 1
B-1300 Z.I. Wavre - Nord
Belgium
Tel: +32 10 23 05 11
info@osg-belgium.com

OSG IBÉRICA

Bekolarra 4
E - 01010 Vitoria-Gasteiz
Spain
Tel: +34 945 242 400
osg.iberica@osg-ib.com

OSG FRANCE

Parc Icade, Paris Nord 2
Immeuble "Le Rimbaud"
22 Avenue des Nations
CS66191 - 93420 Villepinte
France
Tel: +33 1 49 90 10 10
sales@osg-france.com

OSG ITALY

Via Ferrero, 65 A/B
I - 10098 Rivoli
Italy
Tel: +39 0117705211
info@osg-italia.it



OSG IN EUROPE

CZECH REPUBLIC, SLOVAKIA, HUNGARY

OSG Europe Logistics S.A.
Slovakia, organizačná zložka
Račianska 22/A, Bratislava 831 02
Slovakia
Tel.: +421 24 32 91 295
info@osgeurope.com

OSG POLAND

ul. Spółdzielcza 57
05-074 Halinów
Polska
Tel: +22 760 82 71
Mob. +48 570 677 711
osg@osg-poland.com

OSG ROMANIA SRL

25C, Bucuresti-Magurele Street (Sector 5)
051431 Bucuresti
România
Tel: +40 21 322 07 47
info@osgromania.ro

OSG TURKEY

Rami Kişla Cad.No:56 Eyüp
Istanbul 34056
Turkey
Tel: +90 212 565 24 00
Fax: +90 212 565 44 00
info@osg-turkey.com

Vischer & Bolli AG

Machining and Workholding
Im Schossacher 17
CH-8600 Dübendorf
Switzerland
Tel.: +41 44 802 15 15
info@vb-tools.com

OSG GERMANY

Karl-Ehmann-Str. 25
D - 73037 Göppingen
Germany
Tel: +49 7161 6064 - 0
Fax: +49 7161 6064 - 444
info@osg-germany.de



shaping your dreams

OSG EUROPE LOGISTICS

Avenue Lavoisier 1
B-1300 Z.I. Wavre - Nord - Belgium
Tel: +32 10 23 05 07
info@osgeurope.com

OSG POLAND Sp. z o.o.

Spółdzielcza 57
05-074 Halinów - Poland
Tel: +22 760 82 71
osg@osg-poland.com

OSG ROMANIA SRL

25C, Bucuresti-Magurele Street (Sector 5)
051431 Bucuresti - România
Tel: +40 21 322 07 47
info@osgromania.ro

OSG BELUX

Avenue Lavoisier 1
B-1300 Z.I. Wavre - Nord - Belgium
Tel: +32 10 23 05 11
info@osg-belgium.com

OSG GERMANY

Karl-Ehmann-Str. 25
D - 73037 Göppingen - Germany
Tel: +49 7161 6064 - 0
Fax: +49 7161 6064 - 444
info@osg-germany.de

AUSTRIA

Branch office of OSG GERMANY
Messestraße 11
A-6850 Dornbirn
Tel: +49 7161 6064-0
info@osg-germany.de

OSG FRANCE

Parc Icade, Paris Nord 2
Immeuble "Le Rimbaud"
22 Avenue des Nations
CS66191 - 93420 Villepinte - France
Tel: +33 1 49 90 10 10
sales@osg-france.com

OSG SCANDINAVIA

(For Scandinavian countries)
Langebjergvaenget 16
4000 Roskilde - Denmark
Tel: +45 46 75 65 55
osg@osg-scandinavia.com

OSG ITALIA

Via Ferrero, 65 A/B3
I - 10098 Rivoli - Italy
Tel: +39 0117705211
info@osg-italia.it

OSG NETHERLANDS

Bedrijfsweg 5 - 3481 MG Harmelen
Tel: +31 348 44 2764
info@osg-nl.com

SWEDEN

Branch office of OSG SCANDINAVIA
Singelgatan 7
212 28 Malmö - Sweden
Tel: +46 40 41 22 55
osg@osg-scandinavia.com

Vischer & Bolli AG

Machining and Workholding
Im Schossacher 17
CH-8600 Dübendorf
T +41 44 802 15 15
info@vb-tools.com

OSG UK

Kelsey Close, Attleborough Fields Ind Est,
CV11 6RS, Nuneaton, United Kingdom.
Tel: +44 1827 720 013
uk_sales@osg-uk.com

OSG IBERICA

Bekolarra 4
E - 01010 Vitoria-Gasteiz - Spain
Tel: +34 945 242 400
osg.iberica@osg-ib.com

CZECH, SLOVAKIA, HUNGARY

OSG Europe Logistics S.A.
Slovakia organizacna zlozka
Racianská 22/A, SK-83102 Bratislava
Slovakia
Tel. +421 24 32 91 295
Orders-osgsvk@osgeurope.com

OSG TURKEY

Rami Kışla Cad.No:56 Eyüp
Istanbul 34056 - Turkey
Tel+90 212 565 24 00
Fax: +90 212 565 44 00
info@osg-turkey.com

OSG EUROPE LOGISTICS S.A.

04/2023 - All rights reserved. © OSG Europe 2023.

The contents of this catalogue are provided to you for viewing only. They are not intended for reproduction either in part or in whole in this or other medium. They cannot be copied, used to create derivation work or used for any reason, by means without the express, written permission of the copyright owner. If prices are stated, they are netto unit-prices and any eventual tax(es) have to be added. The company is not responsible for any printing error in technical, price and/or any other data.

Tool specifications subject to change without notice.

www.osgeurope.com

