



Finally, the answer you've been looking for is here

# A-TAP SERIES

Volume 8



# INDEX

---

## Blind Hole

### Metric

A-SFT .....	PAGE 8
A-OIL-SFT .....	PAGE 9
A-SFT-6GX .....	PAGE 10
A-SFT-7GX .....	PAGE 11
A-SFT FORM E .....	PAGE 12
A-SFT + 0.1 .....	PAGE 13
A-LT-SFT .....	PAGE 14
A-SFT-LH .....	PAGE 15
A-SFT-HB Weldon Shank .....	PAGE 16

### Metric Fine

A-SFT .....	PAGE 17
A-OIL-SFT .....	PAGE 18
A-SFT-6GX .....	PAGE 19

### UNC

A-SFT .....	PAGE 20
-------------	---------

### UNF

A-SFT .....	PAGE 21
-------------	---------

### G (BSP)

A-SFT .....	PAGE 22
-------------	---------

### BSW

A-SFT .....	PAGE 23
-------------	---------

### BSF

A-SFT .....	PAGE 24
-------------	---------

### BA

A-SFT .....	PAGE 25
-------------	---------

### Rc (BSPT)

A-TPT .....	PAGE 26
-------------	---------

### Rc (ISO)

A-SFT Rc .....	PAGE 27
----------------	---------

---

# Through Hole

## Metric

A-POT <b>NEW SIZES</b> .....	PAGE 28
A-OIL-POT .....	PAGE 29
A-POT-6GX .....	PAGE 30
A-POT-7GX .....	PAGE 31
A-POT + 0.1 .....	PAGE 32
A-LT-POT .....	PAGE 33
A-POT-LH .....	PAGE 34
A-POT-HB Weldon Shank .....	PAGE 35

## Metric Fine

A-POT .....	PAGE 36
A-OIL-POT .....	PAGE 37
A-POT-6GX .....	PAGE 38

## UNC

A-POT .....	PAGE 39
-------------	---------

## UNF

A-POT .....	PAGE 40
-------------	---------

## G (BSP)

A-POT .....	PAGE 41
-------------	---------

## BSW

A-POT .....	PAGE 42
-------------	---------

## BSF

A-POT .....	PAGE 43
-------------	---------

## BA

A-POT .....	PAGE 44
-------------	---------

Finally, the answer you've been looking for is here...

**1** Stabilize chip shape  
Sharp cutting edge

**2** Accelerate chip evacuation  
Variable lead flute (PAT.)

**3** High wear resistance  
V coating

**4** High wear resistance  
Powder Metallurgy HSS (CPM)



# OSG'S NEW PREMIUM BRAND "A-TAP SERIES"

## The answer for your troubles lies here

Most of tapping troubles are caused by unstable chip evacuation.

A-TAP Series resolve such troubles and apply to a wide range of work materials and cutting speed.

### Tapping Troubles

N°1 breakage and chipping	26 %
N°2 dimensional error	17 %
N°3 galling	14 %
Others	43 %

### Main factor is chip packing

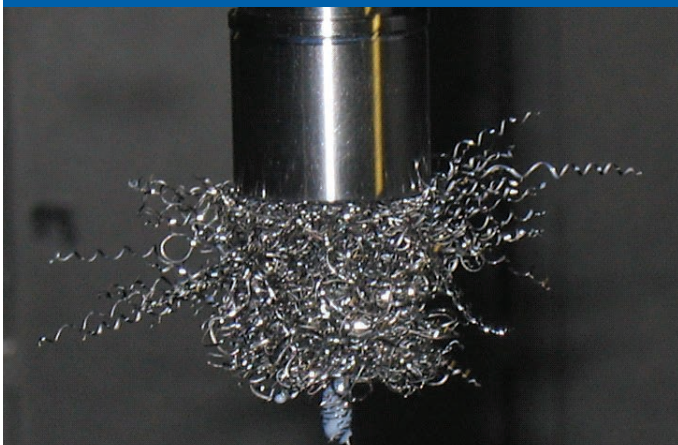

The biggest advantage of A-TAP Series:

## THE BEST CHIP EVACUATION



Conventional Tap

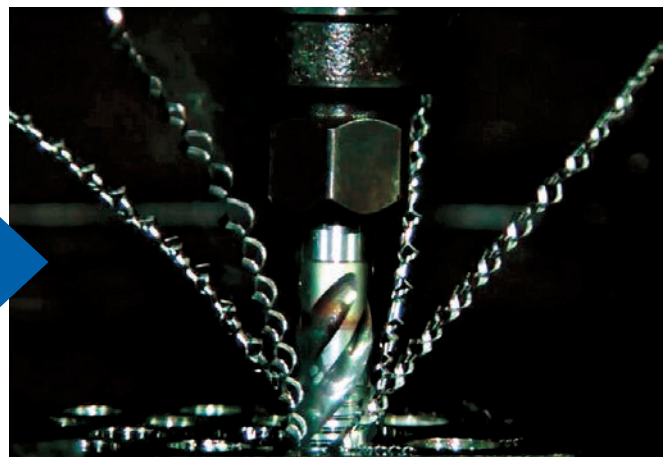

A-SFT

# KEY FEATURES A-TAP SERIES

## Applies to a wide variety of work materials

Even to mild steel and stainless steel



## High performance in machining center

Applies to a wide cutting range

Long

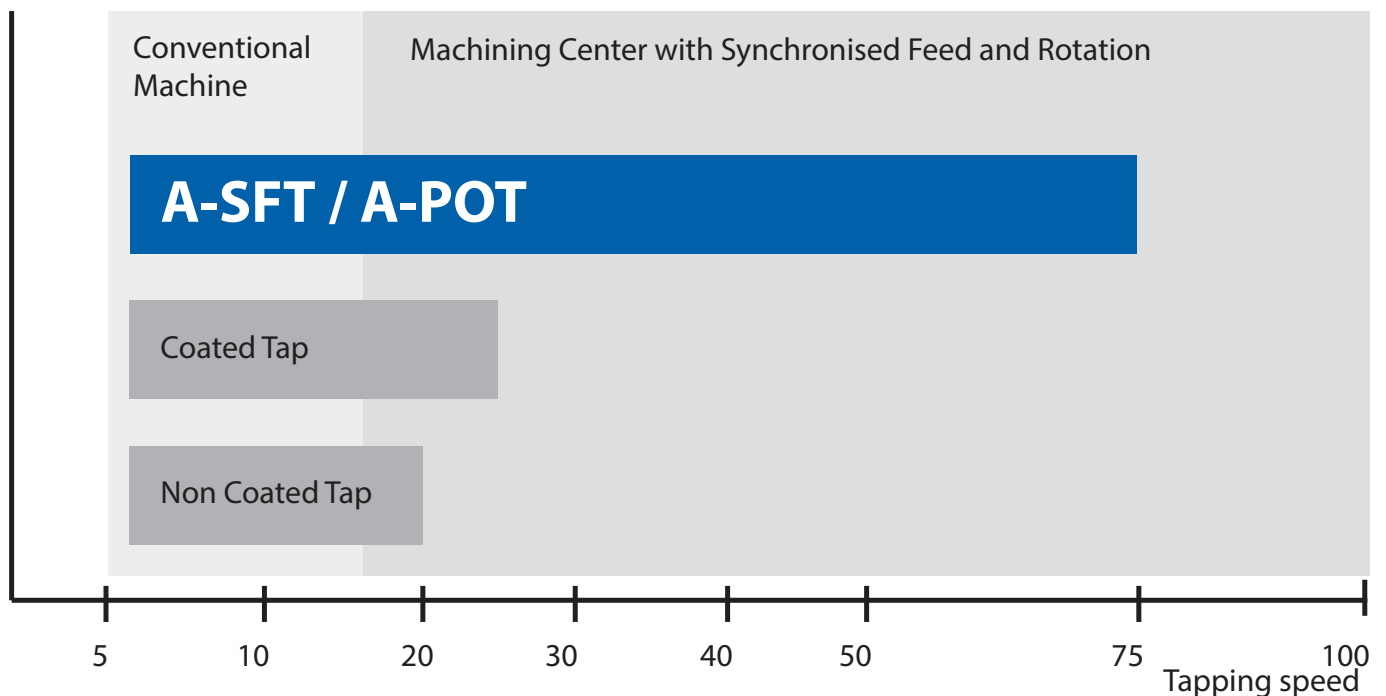

- It is a image of tapping in medium and high carbon steel with water soluble coolant.
- Machining center with synchronized feed and rotation is recommended for more than 15m/min.
- As the best speed varies by tapping condition, please find it by trials.

## ■ SUS304

### Deep Hole Tapping (2D) in stainless steel

High performance achieved in stainless steel with water soluble oil



■ Cutting edge after 1.000 holes tapping

Tool	A-SFT M8x1,25
Work Material	SUS304
Hole Size	Ø6,8x22mm (Blind)
Tapping Length	16mm (2D)
Tapping Speed	10m/min (398min <sup>-1</sup> )
Coolant	Water Soluble Chlorine-Free (10%)
Machine	Vertical Synchronized Machining Center

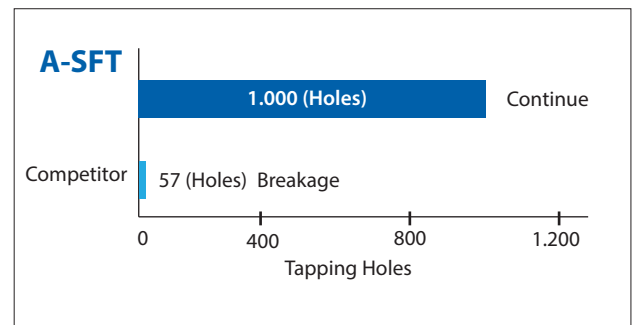

## ■ S45C

### High speed tapping by machining center

Tapping operation in 15,30,40m/min are all stable

Tool	A-SFT M6x1
Work Material	S45C
Hole Size	Ø5x16mm (Blind)
Tapping Length	12mm (2D)
Coolant	Water Soluble Chlorine-Free (10%)
Machine	Vertical Synchronized Machining Center

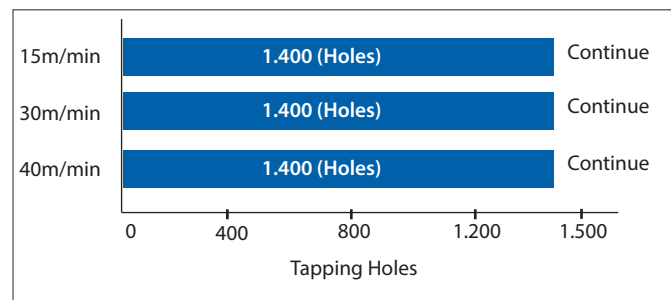

■ Cutting edge after 1.400 holes Tapping

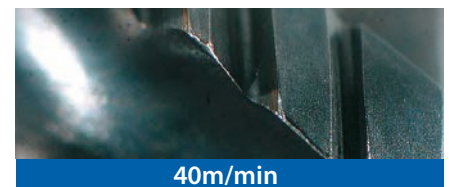
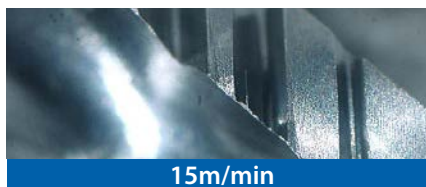

■ Chip generated in 40m/min



# A-SFT

Threading | Cutting taps | Metric



- First choice in quality and performance
- Powder metal spiral-fluted cutting tap for blind holes
- Multilayer TiCN coating
- High speed tapping in general steels, aluminium, stainless steels

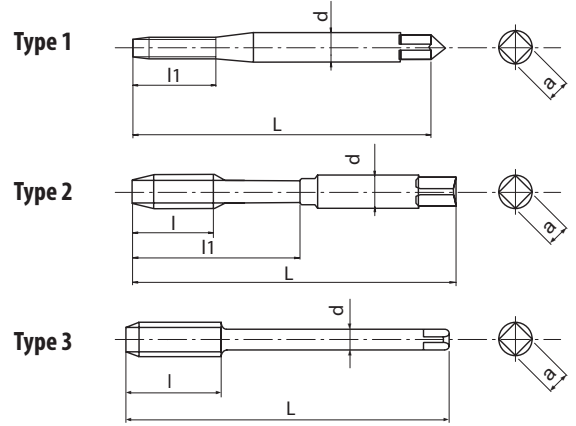

Threading | Cutting taps

<b>P</b> C < 0,2%	<b>P</b> 0,25 < C < 0,4	<b>P</b> C > 0,45%	<b>P</b> SCM	<b>M</b> INOX	<b>N</b> Al	<b>N</b> AC,ADC	<b>S</b> Ti	<b>H</b> 25-35 HRC		m/min
15-60	15-60	10-60	8-30	8-20	15-35	15-35	5-10	8-20		

<b>A</b>	<b>M</b>	<b>PM</b>	<b>V</b>	<b>45°</b>	<b>ISO 2 6HX</b>	<b>C/2,5</b>	<b>DIN 371</b>	<b>DIN 376</b>
----------	----------	-----------	----------	------------	------------------	--------------	----------------	----------------

\* Tolerance 5HX

Metric

EDP	M	P	L	l	l1	d	a	Z	Type	DIN	Price
*48139111	1	0,25	40	-	5	2,5	2,1	2	1	DIN371	
*48139112	1,1	0,25	40	-	5	2,5	2,1	2	1	DIN371	
*48139113	1,2	0,25	40	-	5	2,5	2,1	2	1	DIN371	
*48139115	1,4	0,3	40	-	6	2,5	2,1	2	1	DIN371	
48139118	1,6	0,35	40	-	7	2,5	2,1	2	1	DIN371	
48139119	1,7	0,35	40	-	8	2,5	2,1	2	1	DIN371	
48139120	1,8	0,35	40	-	8	2,5	2,1	2	1	DIN371	
48139125	2	0,4	45	3,2	10	2,8	2,1	2	2	DIN371	
48139127	2,2	0,45	45	3,6	11	2,8	2,1	2	2	DIN371	
48139128	2,3	0,4	45	3,6	12	2,8	2,1	2	2	DIN371	
48139133	2,5	0,45	50	3,6	13	2,8	2,1	2	2	DIN371	
48139136	2,6	0,45	50	3,6	13	2,8	2,1	2	2	DIN371	
48139138	3	0,5	56	4	18	3,5	2,7	3	2	DIN371	
48139142	3,5	0,6	56	4,8	20	4	3	3	2	DIN371	
48139144	4	0,7	63	5,6	21	4,5	3,4	3	2	DIN371	
48139147	4,5	0,75	70	6	25	6	4,9	3	2	DIN371	
48139149	5	0,8	70	6,4	25	6	4,9	3	2	DIN371	
48139152	5,5	0,9	80	7,2	30	6	4,9	3	2	DIN371	
48139155	6	1	80	8	30	6	4,9	3	2	DIN371	
48139158	7	1	80	8	30	7	5,5	3	2	DIN371	
48139161	8	1,25	90	10	35	8	6,2	3	2	DIN371	
48139165	9	1,25	90	10	35	9	7	3	2	DIN371	
48139169	10	1,5	100	12	39	10	8	3	2	DIN371	
48139139	3	0,5	56	4	-	2,2	-	3	3	DIN376	
48139185	4	0,7	63	5,6	-	2,8	2,1	3	3	DIN376	
48139150	5	0,8	70	6,4	-	3,5	2,7	3	3	DIN376	
48139187	6	1	80	8	-	4,5	3,4	3	3	DIN376	
48139159	7	1	80	8	-	5,5	4,3	3	3	DIN376	
48139188	8	1,25	90	10	-	6	4,9	3	3	DIN376	
48139166	9	1,25	90	10	-	7	5,5	3	3	DIN376	
48139189	10	1,5	100	12	-	7	5,5	3	3	DIN376	
48139175	11	1,5	100	12	-	8	6,2	3	3	DIN376	
48139179	12	1,75	110	14	-	9	7	3	3	DIN376	
48139191	14	2	110	16	-	11	9	3	3	DIN376	
48139202	16	2	110	16	-	12	9	3	3	DIN376	
48139214	18	2,5	125	25	-	14	11	4	3	DIN376	
48139228	20	2,5	140	25	-	16	12	4	3	DIN376	
48139238	22	2,5	140	25	-	18	14,5	4	3	DIN376	
48139247	24	3	160	30	-	18	14,5	4	3	DIN376	



# A-OIL-SFT

Threading | Cutting taps | Metric

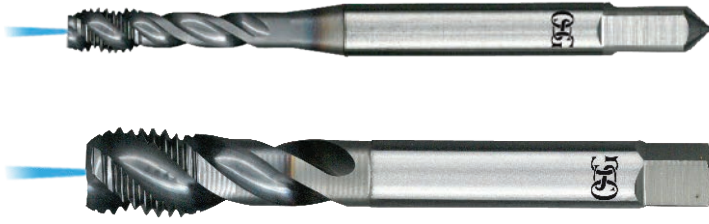

Type 1

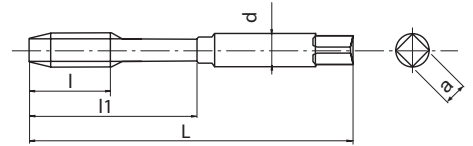

Type 2

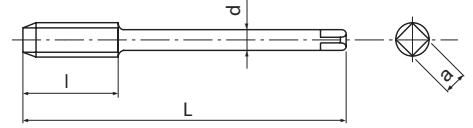

- First choice in quality and performance
- Powder metal spiral-fluted cutting tap for blind holes
- Multilayer TiCN coating
- High speed tapping in general steels, aluminium, stainless steels
- Centre through coolant

<b>P</b>	<b>P</b>	<b>P</b>	<b>P</b>	<b>M</b>	<b>N</b>	<b>N</b>	<b>S</b>	<b>H</b>	
C < 0,2%	0,25 < C < 0,4	C > 0,45%	SCM	INOX	Al	AC,ADC	Ti	25-35 HRC	
15-60	15-60	10-60	8-30	8-20	15-35	15-35	5-10	8-20	m/min

<b>A</b>	<b>M</b>	<b>PM</b>	<b>V</b>	<b>45°</b>	<b>ISO 2 6HX</b>	<b>C/2,5</b>			<b>DIN 371</b>	<b>DIN 376</b>
----------	----------	-----------	----------	------------	------------------	--------------	--	--	----------------	----------------

EDP	M	P	L	l	l1	d	a	Z	Type	DIN	Price
48140155	6	1	80	8	30	6	4,9	3	1	DIN371	
48140161	8	1,25	90	10	35	8	6,2	3	1	DIN371	
48140169	10	1,5	100	12	39	10	8	3	1	DIN371	
48140179	12	1,75	110	14	-	9	7	3	2	DIN376	
48140191	14	2	110	16	-	11	9	3	2	DIN376	
48140202	16	2	110	16	-	12	9	3	2	DIN376	
48140214	18	2,5	125	25	-	14	11	4	2	DIN376	
48140228	20	2,5	140	25	-	16	12	4	2	DIN376	
48140238	22	2,5	140	25	-	18	14,5	4	2	DIN376	
48140247	24	3	160	30	-	18	14,5	4	2	DIN376	
48140262	27	3	160	36	-	20	16	4	2	DIN376	
48140271	30	3,5	180	42	-	22	18	4	2	DIN376	
48140281	33	3,5	180	42	-	25	20	4	2	DIN376	
48140294	36	4	200	48	-	28	22	4	2	DIN376	
48140304	39	4	200	48	-	32	24	4	2	DIN376	
48140314	42	4,5	200	54	-	32	24	4	2	DIN376	
48140319	45	4,5	220	54	-	36	29	4	2	DIN376	
48140325	48	5	250	60	-	36	29	4	2	DIN376	
48140337	52	5	250	60	-	40	32	4	2	DIN376	
48140347	56	5,5	250	66	-	40	32	4	2	DIN376	

Threading | Cutting taps

Metric

# A-SFT 6GX

Threading | Cutting taps | Metric

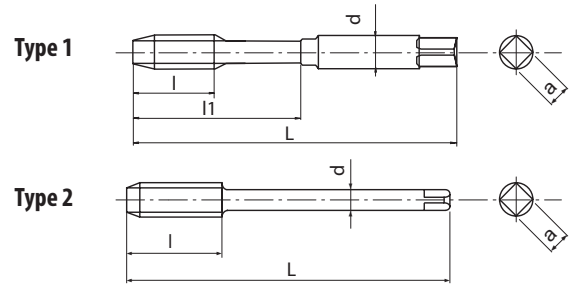

- First choice in quality and performance
- Powder metal spiral-fluted cutting tap for blind holes
- Multilayer TiCN coating
- High speed tapping in general steels, aluminium, stainless steels
- For 6G internal thread tolerance

Threading | Cutting taps

<b>P</b> C < 0,2%	<b>P</b> 0,25 < C < 0,4	<b>P</b> C > 0,45%	<b>P</b> SCM	<b>M</b> INOX	<b>N</b> Al	<b>N</b> AC,ADC	<b>S</b> Ti	<b>H</b> 25-35 HRC	m/min
15-60	15-60	10-60	8-30	8-20	15-35	15-35	5-10	8-20	

<b>A</b>	<b>M</b>	<b>PM</b>	<b>V</b>	45°	<b>ISO 3 6GX</b>	C/2,5	<b>DIN 371</b>	<b>DIN 376</b>
----------	----------	-----------	----------	-----	------------------	-------	----------------	----------------

Metric

EDP	M	P	oversize	L	l	l1	d	a	Z	Type	DIN	Price
48201125	2	0,4	+0,019	45	3,2	10	2,8	2,1	2	1	DIN371	
48201133	2,5	0,45	+0,020	50	3,6	13	2,8	2,1	2	1	DIN371	
48201138	3	0,5	+0,020	56	4	18	3,5	2,7	3	1	DIN371	
48201144	4	0,7	+0,022	63	5,6	21	4,5	3,4	3	1	DIN371	
48201149	5	0,8	+0,024	70	6,4	25	6	4,9	3	1	DIN371	
48201155	6	1	+0,026	80	8	30	6	4,9	3	1	DIN371	
48201161	8	1,25	+0,028	90	10	35	8	6,2	3	1	DIN371	
48201169	10	1,5	+0,032	100	12	39	10	8	3	1	DIN371	
48201179	12	1,75	+0,034	110	14	-	9	7	3	2	DIN376	
48201202	16	2	+0,038	110	16	-	12	9	3	2	DIN376	

# A-SFT 7GX

Threading | Cutting taps | Metric



Type 1

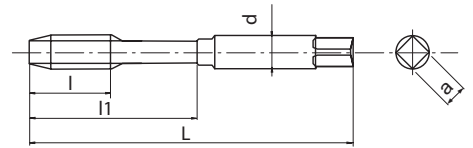

Type 2

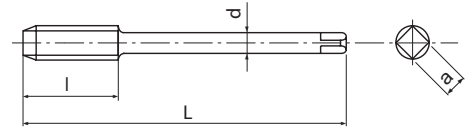

- First choice in quality and performance
- Powder metal spiral-fluted cutting tap for blind holes
- Multilayer TiCN coating
- High speed tapping in general steels, aluminium, stainless steels
- For 7G internal thread tolerance

<b>P</b>	<b>P</b>	<b>P</b>	<b>P</b>	<b>M</b>	<b>N</b>	<b>N</b>	<b>S</b>	<b>H</b>	
C < 0,2%	0,25 < C < 0,4	C > 0,45%	SCM	INOX	Al	AC,ADC	Ti	25-35 HRC	
15-60	15-60	10-60	8-30	8-20	15-35	15-35	5-10	8-20	m/min

<b>A</b>	<b>M</b>	<b>PM</b>	<b>V</b>	<b>45°</b>	<b>7GX</b>	<b>C/2,5</b>		<b>DIN 371</b>	<b>DIN 376</b>
----------	----------	-----------	----------	------------	------------	--------------	--	----------------	----------------

EDP	M	P	oversize	L	l	l1	d	a	Z	Type	DIN	Price
48202125	2	0,4	+0,038	45	3,2	10	2,8	2,1	2	1	DIN371	
48202133	2,5	0,45	+0,040	50	3,6	13	2,8	2,1	2	1	DIN371	
48202138	3	0,5	+0,040	56	4	18	3,5	2,7	3	1	DIN371	
48202144	4	0,7	+0,044	63	5,6	21	4,5	3,4	3	1	DIN371	
48202149	5	0,8	+0,048	70	6,4	25	6	4,9	3	1	DIN371	
48202155	6	1	+0,052	80	8	30	6	4,9	3	1	DIN371	
48202161	8	1,25	+0,056	90	10	35	8	6,2	3	1	DIN371	
48202169	10	1,5	+0,064	100	12	39	10	8	3	1	DIN371	
48202179	12	1,75	+0,068	110	14	-	9	7	3	2	DIN376	
48202202	16	2	+0,076	110	16	-	12	9	3	2	DIN376	



# A-SFT FORM E

Threading | Cutting taps | Metric



Type 1

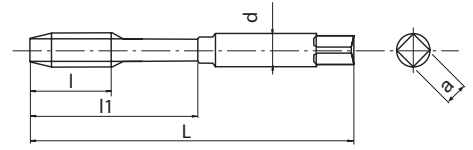

Type 2

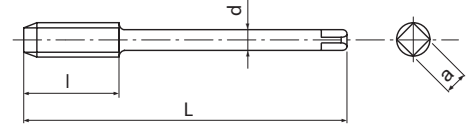

- First choice in quality and performance
- Powder metal spiral-fluted cutting tap for blind holes
- Multilayer TiCN coating
- High speed tapping in general steels, aluminium, stainless steels
- Form E chamfer

Threading | Cutting taps

<b>P</b>	<b>P</b>	<b>P</b>	<b>P</b>	<b>M</b>	<b>N</b>	<b>N</b>	<b>S</b>	<b>H</b>	
C < 0,2%	0,25 < C < 0,4	C > 0,45%	SCM	INOX	Al	AC,ADC	Ti	25-35 HRC	
15-60	15-60	10-60	8-30	8-20	15-35	15-35	5-10	8-20	m/min

<b>A</b>	<b>M</b>	<b>PM</b>	<b>V</b>	<b>45°</b>	<b>ISO 2 6HX</b>	<b>E/1,5</b>	<b>DIN 371</b>	<b>DIN 376</b>
----------	----------	-----------	----------	------------	------------------	--------------	----------------	----------------

EDP	M	P	L	l	l1	d	a	Z	Type	DIN	Price
48203138	3	0,5	56	4	18	3,5	2,7	3	1	DIN371	
48203144	4	0,7	63	5,6	21	4,5	3,4	3	1	DIN371	
48203149	5	0,8	70	6,4	25	6	4,9	3	1	DIN371	
48203155	6	1	80	8	30	6	4,9	3	1	DIN371	
48203161	8	1,25	90	10	35	8	6,2	3	1	DIN371	
48203169	10	1,5	100	12	39	10	8	3	1	DIN371	
48203179	12	1,75	110	14	-	9	7	3	2	DIN376	
48203191	14	2	110	16	-	11	9	3	2	DIN376	
48203202	16	2	110	16	-	12	9	3	2	DIN376	

Metric

# A-SFT+0.1

Threading | Cutting taps | Metric

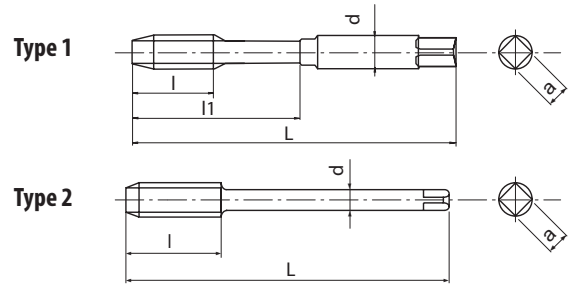

- First choice in quality and performance
- Powder metal spiral-fluted cutting tap for blind holes
- Multilayer TiCN coating
- High speed tapping in general steels, aluminium, stainless steels
- Oversized tap for 6H +0,1mm thread tolerance

<b>P</b>	<b>P</b>	<b>P</b>	<b>P</b>	<b>M</b>	<b>N</b>	<b>N</b>	<b>S</b>	<b>H</b>	
C < 0,2%	0,25 < C < 0,4	C > 0,45%	SCM	INOX	Al	AC,ADC	Ti	25-35 HRC	
15-60	15-60	10-60	8-30	8-20	15-35	15-35	5-10	8-20	m/min

<b>A</b>	<b>M</b>	<b>PM</b>	<b>V</b>	<b>45°</b>	<b>6H +0.1</b>	<b>C/2,5</b>		<b>DIN 371</b>	<b>DIN 376</b>
----------	----------	-----------	----------	------------	----------------	--------------	--	----------------	----------------

EDP	M	P	L	l	l1	d	a	Z	Type	DIN	Price
48204138	3	0,5	56	4	18	3,5	2,7	3	1	DIN371	
48204144	4	0,7	63	5,6	21	4,5	3,4	3	1	DIN371	
48204149	5	0,8	70	6,4	25	6	4,9	3	1	DIN371	
48204155	6	1	80	8	30	6	4,9	3	1	DIN371	
48204161	8	1,25	90	10	35	8	6,2	3	1	DIN371	
48204169	10	1,5	100	12	39	10	8	3	1	DIN371	
48204179	12	1,75	110	14	-	9	7	3	2	DIN376	
48204202	16	2	110	16	-	12	9	3	2	DIN376	

Threading | Cutting taps



Metric

# A-LT-SFT

Threading | Cutting taps | Metric



Type 1

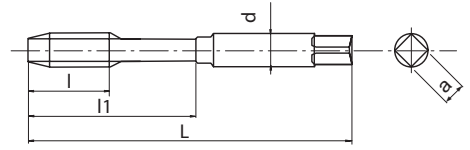

Type 2

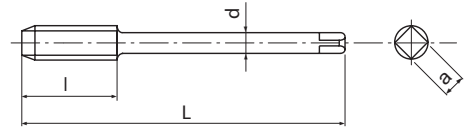

- First choice in quality and performance
- Powder metal spiral-fluted cutting tap for blind holes
- Multilayer TiCN coating
- High speed tapping in general steels, aluminium, stainless steels
- With long shank for long reach threading

Threading | Cutting taps

<b>P</b> C < 0,2%	<b>P</b> 0,25 < C < 0,4	<b>P</b> C > 0,45%	<b>P</b> SCM	<b>M</b> INOX	<b>N</b> Al	<b>N</b> AC,ADC	<b>S</b> Ti	<b>H</b> 25-35 HRC	m/min
15-25	15-25	10-25	8-20	8-20	15-35	15-35	5-10	8-20	

<b>A</b>	<b>M</b>	<b>PM</b>	<b>V</b>	<b>45°</b>	<b>ISO 2 6HX</b>	<b>C/2,5</b>
----------	----------	-----------	----------	------------	------------------	--------------

Metric

EDP	M	P	L	l	l1	d	a	Z	Type	Price
48208125	2	0,4	80	3,2	10	2,8	2,1	2	1	
48208133	2,5	0,45	100	3,6	13	2,8	2,1	2	1	
48208138	3	0,5	100	4	18	3,5	2,7	3	1	
48208144	4	0,7	125	5,6	21	4,5	3,4	3	1	
48208149	5	0,8	160	6,4	25	6	4,9	3	1	
48208155	6	1	160	8	30	6	4,9	3	1	
48208161	8	1,25	180	10	35	8	6,2	3	1	
48208169	10	1,5	200	12	39	10	8	3	1	
48209155	6	1	160	10	-	4,5	3,4	3	2	
48209161	8	1,25	180	11	-	6	4,9	3	2	
48209169	10	1,5	200	14	-	7	5,5	3	2	
48209179	12	1,75	200	14	-	9	7	3	2	
48209191	14	2	200	16	-	11	9	3	2	
48209202	16	2	200	16	-	12	9	3	2	
48209214	18	2,5	200	25	-	14	11	4	2	
48209228	20	2,5	200	25	-	16	12	4	2	

# A-SFT-LH

Threading | Cutting taps | Metric



Type 1

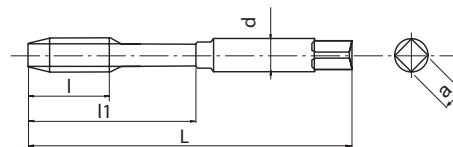

Type 2

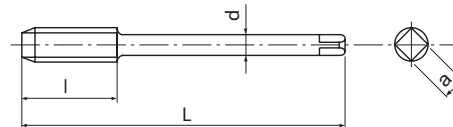

- First choice in quality and performance
- Powder metal spiral-fluted cutting tap for blind holes
- Multilayer TiCN coating
- High speed tapping in general steels, aluminium, stainless steels
- For left-hand threads

<b>P</b> C < 0,2%	<b>P</b> 0,25 < C < 0,4	<b>P</b> C > 0,45%	<b>P</b> SCM	<b>M</b> INOX	<b>N</b> Al	<b>N</b> AC,ADC	<b>S</b> Ti	<b>H</b> 25-35 HRC	
15-60	15-60	10-60	8-30	8-20	15-35	15-35	5-10	8-20	m/min

<b>A</b>	<b>M</b>	<b>PM</b>	<b>V</b>	45°	ISO 2 6HX	C/2,5		DIN 371	DIN 376	LH
----------	----------	-----------	----------	-----	--------------	-------	--	---------	---------	----

EDP	M	P	L	l	l1	d	a	Z	Type	DIN	Price
48217138	3	0,5	56	4	18	3,5	2,7	3	1	DIN371	
48217144	4	0,7	63	5,6	21	4,5	3,4	3	1	DIN371	
48217149	5	0,8	70	6,4	25	6	4,9	3	1	DIN371	
48217155	6	1	80	8	30	6	4,9	3	1	DIN371	
48217161	8	1,25	90	10	35	8	6,2	3	1	DIN371	
48217169	10	1,5	100	12	39	10	8	3	1	DIN371	
48217179	12	1,75	110	14	-	9	7	3	2	DIN376	
48217191	14	2	110	16	-	11	9	3	2	DIN376	
48217202	16	2	110	16	-	12	9	3	2	DIN376	
48217214	18	2,5	125	25	-	14	11	4	2	DIN376	
48217228	20	2,5	140	25	-	16	12	4	2	DIN376	
48217238	22	2,5	140	25	-	18	14,5	4	2	DIN376	
48217247	24	3	160	30	-	18	14,5	4	2	DIN376	

Threading | Cutting taps



Metric

# A-SFT-HB Weldon

Threading | Cutting taps | Metric

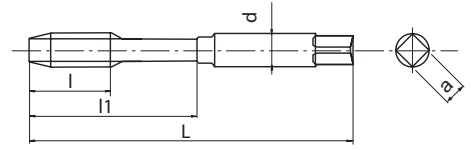

- First choice in quality and performance
- Powder metal spiral-fluted cutting tap for blind holes
- Multilayer TiCN coating
- High speed tapping in general steels, aluminium, stainless steels
- With Weldon shank

Threading | Cutting taps

<b>P</b> C < 0,2%	<b>P</b> 0,25 < C < 0,4	<b>P</b> C > 0,45%	<b>P</b> SCM	<b>M</b> INOX	<b>N</b> Al	<b>N</b> AC,ADC	<b>S</b> Ti	<b>H</b> 25-35 HRC		m/min
15-60	15-60	10-60	8-30	8-20	15-35	15-35	5-10	8-20		

<b>A</b>	<b>M</b>	<b>PM</b>	<b>V</b>	<b>45°</b>	<b>ISO 2 6HX</b>	<b>C/2,5</b>	<b>DIN 371</b>	<b>DIN 1835</b>	<b>HB</b>
----------	----------	-----------	----------	------------	------------------	--------------	----------------	-----------------	-----------

EDP	M	P	L	l	l1	d	a	Z	DIN	Price
48220138	3	0,5	56	4	18	6	4,9	3	DIN371/1835	
48220144	4	0,7	63	5,6	21	6	4,9	3	DIN371/1835	
48220149	5	0,8	70	6,4	25	6	4,9	3	DIN371/1835	
48220155	6	1	80	8	30	6	4,9	3	DIN371/1835	
48220161	8	1,25	90	10	35	8	6,2	3	DIN371/1835	
48220169	10	1,5	100	12	39	10	8	3	DIN371/1835	
48220179	12	1,75	110	14	46	12	9	3	DIN371/1835	
48220191	14	2	110	16	49	14	11	3	DIN371/1835	
48220202	16	2	110	16	56	16	12	3	DIN371/1835	

Metric



# A-SFT

Threading | Cutting taps | Metric Fine

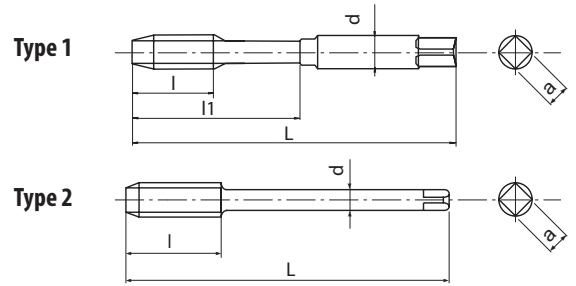

- First choice in quality and performance
- Powder metal spiral-fluted cutting tap for blind holes
- Multilayer TiCN coating
- High speed tapping in general steels, aluminium, stainless steels

<b>P</b> C < 0,2%	<b>P</b> 0,25 < C < 0,4	<b>P</b> C > 0,45%	<b>P</b> SCM	<b>M</b> INOX	<b>N</b> Al	<b>N</b> AC,ADC	<b>S</b> Ti	<b>H</b> 25-35 HRC		m/min
15-60	15-60	10-60	8-30	8-20	15-35	15-35	5-10	8-20		

<b>A</b>	<b>MF</b>	<b>PM</b>	<b>V</b>	<b>45°</b>	<b>ISO 2 6HX</b>	<b>C/2,5</b>	<b>DIN 371</b>	<b>DIN 374</b>
----------	-----------	-----------	----------	------------	------------------	--------------	----------------	----------------

EDP	MF	P	L	l	l1	d	a	Z	Type	DIN	Price
48139135	2,5	0,35	50	3,6	13	2,8	2,1	2	1	DIN371	
48139137	2,6	0,35	50	3,6	13	2,8	2,1	2	1	DIN371	
48139141	3	0,35	56	4	18	3,5	2,7	3	1	DIN371	
48139143	3,5	0,35	56	4,8	20	4	3	3	1	DIN371	
48139145	4	0,5	63	5,6	21	4,5	3,4	3	1	DIN371	
48139146	4	0,35	63	5,6	21	4,5	3,4	3	1	DIN371	
48139148	4,5	0,5	70	6	25	6	4,9	3	1	DIN371	
48139151	5	0,5	70	6,4	25	6	4,9	3	1	DIN371	
48139601	6	0,75	80	8	30	6	4,9	3	1	DIN371	
48139602	6	0,5	80	8	30	6	4,9	3	1	DIN371	
48139160	7	0,75	80	8	30	7	5,5	3	1	DIN371	
48139603	8	1	90	10	35	8	6,2	3	1	DIN371	
48139604	8	0,75	80	10	35	8	6,2	3	1	DIN371	
48139605	9	1	90	10	35	9	7	3	1	DIN371	
48139606	10	1,25	100	12	39	10	8	3	1	DIN371	
48139607	10	1	90	12	35	10	8	3	1	DIN371	
48139608	10	0,75	90	12	35	10	8	3	1	DIN371	
48139156	6	0,75	80	8	-	4,5	3,4	3	2	DIN374	
48139157	6	0,5	80	8	-	4,5	3,4	3	2	DIN374	
48139162	8	1	90	10	-	6	4,9	3	2	DIN374	
48139163	8	0,75	80	8	-	6	4,9	3	2	DIN374	
48139167	9	1	90	10	-	7	5,5	3	2	DIN374	
48139170	10	1,25	100	12	-	7	5,5	3	2	DIN374	
48139171	10	1	90	10	-	7	5,5	3	2	DIN374	
48139172	10	0,75	90	10	-	7	5,5	3	2	DIN374	
48139176	11	1	90	12	-	8	6,2	3	2	DIN374	
48139180	12	1,5	100	14	-	9	7	3	2	DIN374	
48139181	12	1,25	100	12	-	9	7	3	2	DIN374	
48139182	12	1	100	12	-	9	7	3	2	DIN374	
48139192	14	1,5	100	16	-	11	9	3	2	DIN374	
48139193	14	1,25	100	16	-	11	9	3	2	DIN374	
48139194	14	1	100	16	-	11	9	3	2	DIN374	
48139203	16	1,5	100	16	-	12	9	3	2	DIN374	
48139204	16	1	100	16	-	12	9	3	2	DIN374	
48139216	18	1,5	110	16	-	14	11	4	2	DIN374	
48139218	18	1	110	16	-	14	11	4	2	DIN374	
48139220	20	2	140	25	-	16	12	4	2	DIN374	
48139230	20	1,5	125	16	-	16	12	4	2	DIN374	
48139232	20	1	125	16	-	16	12	4	2	DIN374	
48139239	22	2	140	25	-	18	14,5	4	2	DIN374	
48139240	22	1,5	125	16	-	18	14,5	4	2	DIN374	
48139241	22	1	125	16	-	18	14,5	4	2	DIN374	
48139249	24	2	140	30	-	18	14,5	4	2	DIN374	
48139250	24	1,5	140	16	-	18	14,5	4	2	DIN374	
48139251	24	1	140	16	-	18	14,5	4	2	DIN374	



# A-SFT 6GX

Threading | Cutting taps | Metric Fine

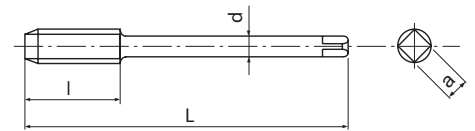

- First choice in quality and performance
- Powder metal spiral-fluted cutting tap for blind holes
- Multilayer TiCN coating
- High speed tapping in general steels, aluminium, stainless steels
- For 6G internal thread tolerance

<b>P</b> C < 0,2%	<b>P</b> 0,25 < C < 0,4	<b>P</b> C > 0,45%	<b>P</b> SCM	<b>M</b> INOX	<b>N</b> Al	<b>N</b> AC,ADC	<b>S</b> Ti	<b>H</b> 25-35 HRC	<b>m/min</b>
15-60	15-60	10-60	8-30	8-20	15-35	15-35	5-10	8-20	

<b>A</b>	<b>MF</b>	<b>PM</b>	<b>V</b>	<b>45°</b>	<b>ISO 3 6GX</b>	<b>C/2,5</b>	<b>DIN 374</b>
----------	-----------	-----------	----------	------------	------------------	--------------	----------------

EDP	MF	P	oversize	L	l	d	a	Z	DIN	Price
48201156	6	0,75	+0,022	80	8	4,5	3,4	3	DIN374	
48201162	8	1	+0,026	90	10	6	4,9	3	DIN374	
48201163	8	0,75	+0,022	80	8	6	4,9	3	DIN374	
48201170	10	1,25	+0,028	100	12	7	5,5	3	DIN374	
48201171	10	1	+0,026	90	10	7	5,5	3	DIN374	
48201180	12	1,5	+0,032	100	14	9	7	3	DIN374	
48201181	12	1,25	+0,028	100	12	9	7	3	DIN374	
48201182	12	1	+0,026	100	12	9	7	3	DIN374	
48201192	14	1,5	+0,032	100	16	11	9	3	DIN374	
48201203	16	1,5	+0,032	100	16	12	9	3	DIN374	
48201216	18	1,5	+0,032	110	16	14	11	4	DIN374	
48201230	20	1,5	+0,032	125	16	16	12	4	DIN374	
48201240	22	1,5	+0,032	125	16	18	14,5	4	DIN374	
48201250	24	1,5	+0,032	140	16	18	14,5	4	DIN374	

# A-SFT

Threading | Cutting taps | UNC

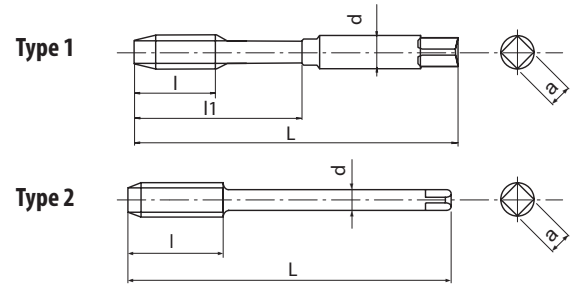

- First choice in quality and performance
- Powder metal spiral-fluted cutting tap for blind holes
- Multilayer TiCN coating
- High speed tapping in general steels, aluminium, stainless steels

<b>P</b> C < 0,2%	<b>P</b> 0,25 < C < 0,4	<b>P</b> C > 0,45%	<b>P</b> SCM	<b>M</b> INOX	<b>N</b> Al	<b>N</b> AC,ADC	<b>S</b> Ti	<b>H</b> 25-35 HRC		m/min
15-60	15-60	10-60	8-30	8-20	15-35	15-35	5-10	8-20		

<b>A</b>	<b>UNC</b>	<b>PM</b>	<b>V</b>	<b>45°</b>	<b>ANSI 2BX</b>	<b>C/2,5</b>	<b>DIN 2184-1</b>	<b>DIN 2184-1</b>
----------	------------	-----------	----------	------------	-----------------	--------------	-------------------	-------------------

EDP	UNC	P	L	l	l1	d	a	Z	Type	DIN	Price
48139453	2	56	45	3,6	11	2,8	2,1	2	1	DIN2184-1	
48139455	3	48	50	3,6	13	2,8	2,1	2	1	DIN2184-1	
48139457	4	40	56	5,1	18	3,5	2,7	2	1	DIN2184-1	
48139459	5	40	56	5,1	18	3,5	2,7	2	1	DIN2184-1	
48139461	6	32	56	6,4	20	4	3	2	1	DIN2184-1	
48139464	8	32	63	6,4	21	4,5	3,4	2	1	DIN2184-1	
48139466	10	24	70	8,5	25	6	4,9	2	1	DIN2184-1	
48139468	12	24	80	8,5	30	6	4,9	2	1	DIN2184-1	
48139471	1/4	20	80	10,2	30	7	5,5	2	1	DIN2184-1	
48139474	5/16	18	90	11,3	35	8	6,2	3	1	DIN2184-1	
48139479	3/8	16	100	12,7	39	10	8	3	1	DIN2184-1	
48139484	7/16	14	100	14,5	-	8	6,2	3	2	DIN2184-1	
48139489	1/2	13	110	15,6	-	9	7	3	2	DIN2184-1	
48139494	9/16	12	110	16,9	-	11	9	3	2	DIN2184-1	
48139501	5/8	11	110	18,5	-	12	9	3	2	DIN2184-1	
48139515	3/4	10	125	25,4	-	14	11	4	2	DIN2184-1	
48139526	7/8	9	140	28,2	-	18	14,5	4	2	DIN2184-1	
48139538	1	8	160	31,8	-	18	14,5	4	2	DIN2184-1	

Threading | Cutting taps



UNC

# A-SFT

Threading | Cutting taps | UNF



Type 1

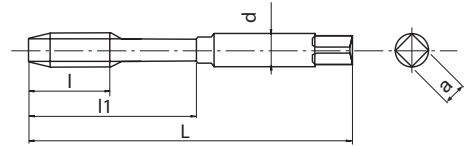

Type 2

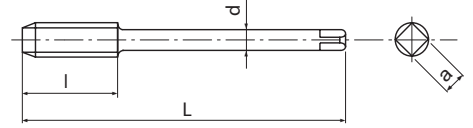

- First choice in quality and performance
- Powder metal spiral-fluted cutting tap for blind holes
- Multilayer TiCN coating
- High speed tapping in general steels, aluminium, stainless steels

<b>P</b>	<b>P</b>	<b>P</b>	<b>P</b>	<b>M</b>	<b>N</b>	<b>N</b>	<b>S</b>	<b>H</b>	
C < 0,2%	0,25 < C < 0,4	C > 0,45%	SCM	INOX	Al	AC,ADC	Ti	25-35 HRC	
15-60	15-60	10-60	8-30	8-20	15-35	15-35	5-10	8-20	m/min

<b>A</b>	<b>UNF</b>	<b>PM</b>	<b>V</b>	<b>45°</b>	<b>ANSI 2BX</b>	<b>C/2,5</b>		<b>DIN 2184-1</b>	<b>DIN 2184-1</b>
----------	------------	-----------	----------	------------	-----------------	--------------	--	-------------------	-------------------

EDP	UNF	P	L	l	l1	d	a	Z	Type	DIN	Price
48139454	2	64	45	3,6	11	2,8	2,1	2	1	DIN2184-1	
48139456	3	56	50	3,6	13	2,8	2,1	2	1	DIN2184-1	
48139458	4	48	56	5,1	18	3,5	2,7	2	1	DIN2184-1	
48139460	5	44	56	5,1	18	3,5	2,7	2	1	DIN2184-1	
48139462	6	40	56	6,4	20	4	3	2	1	DIN2184-1	
48139465	8	36	63	6,4	21	4,5	3,4	2	1	DIN2184-1	
48139467	10	32	70	8,5	25	6	4,9	2	1	DIN2184-1	
48139469	12	28	80	8,5	30	6	4,9	2	1	DIN2184-1	
48139472	1/4	28	80	10,2	30	7	5,5	2	1	DIN2184-1	
48139476	5/16	24	90	11,3	35	8	6,2	3	1	DIN2184-1	
48139481	3/8	24	90	12,7	35	10	8	3	1	DIN2184-1	
48139486	7/16	20	100	14,5	-	8	6,2	3	2	DIN2184-1	
48139491	1/2	20	100	15,6	-	9	7	3	2	DIN2184-1	
48139496	9/16	18	100	16,9	-	11	9	3	2	DIN2184-1	
48139504	5/8	18	100	18,5	-	12	9	3	2	DIN2184-1	
48139517	3/4	16	110	25,4	-	14	11	4	2	DIN2184-1	
48139528	7/8	14	125	28,2	-	18	14,5	4	2	DIN2184-1	
48139539	1	12	140	31,8	-	18	14,5	4	2	DIN2184-1	



# A-SFT

Threading | Cutting taps | G (BSP)

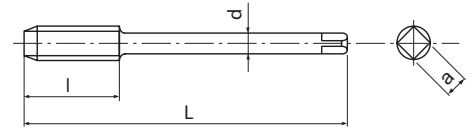

- First choice in quality and performance
- Powder metal spiral-fluted cutting tap for blind holes
- Multilayer TiCN coating
- High speed tapping in general steels, aluminium, stainless steels

Threading | Cutting taps

<b>P</b>	<b>P</b>	<b>P</b>	<b>P</b>	<b>M</b>	<b>N</b>	<b>N</b>	<b>S</b>	<b>H</b>	
C < 0,2%	0,25 < C < 0,4	C > 0,45%	SCM	INOX	Al	AC, ADC	Ti	25-35 HRC	m/min
15-60	15-60	10-60	8-30	8-20	15-35	15-35	5-10	8-20	

<b>A</b>	<b>G</b>	<b>PM</b>	<b>V</b>	<b>45°</b>	<b>C/2,5</b>		<b>DIN 5156</b>
----------	----------	-----------	----------	------------	--------------	--	-----------------

EDP	G	P	L	l	d	a	Z	DIN	Price
48139900	1/8	28	90	20	7	5,5	3	DIN5156	
48139000	1/4	19	100	22	11	9	3	DIN5156	
48139100	3/8	19	100	22	12	9	4	DIN5156	
48139200	1/2	14	125	25	16	12	4	DIN5156	
48139300	5/8	14	125	25	18	14,5	4	DIN5156	
48139400	3/4	14	140	28	20	16	4	DIN5156	
48139500	7/8	14	150	28	22	18	4	DIN5156	
48139600	1	11	160	30	25	20	4	DIN5156	

G (BSP)



# A-SFT

Threading | Cutting taps | BSF

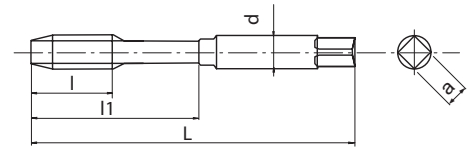

- First choice in quality and performance
- Powder metal spiral-fluted cutting tap for blind holes
- Multilayer TiCN coating
- High speed tapping in general steels, aluminium, stainless steels

Threading | Cutting taps

C < 0,2%	0,25 < C < 0,4	C > 0,45%	SCM	INOX	Al	AC, ADC	Ti	25-35 HRC	<b>m/min</b>
15-60	15-60	10-60	8-30	8-20	15-35	15-35	5-10	8-20	

--	--	--	--	--	--	--

BSF

EDP	BSF	TPI	L	l	l1	d	a	Z	DIN	Price
48139731	1/4	26	80	17	30	7	5,5	3	DIN2184-1	
48139732	5/16	22	90	17	35	8	6,2	3	DIN2184-1	
48139733	3/8	20	100	18	39	10	8	3	DIN2184-1	
48139734	7/16	18	100	22	-	8	6,2	3	DIN2184-1	
48139735	1/2	16	100	22	-	9	7	3	DIN2184-1	
48139737	5/8	14	110	27	-	12	9	3	DIN2184-1	
48139739	3/4	12	125	27	-	14	11	3	DIN2184-1	
48139742	1	10	160	36	-	18	14,5	3	DIN2184-1	



# A-SFT

Threading | Cutting taps | BA

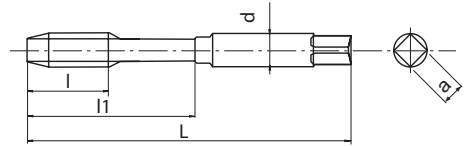

- First choice in quality and performance
- Powder metal spiral-fluted cutting tap for blind holes
- Multilayer TiCN coating
- High speed tapping in general steels, aluminium, stainless steels

<b>P</b> C < 0,2%	<b>P</b> 0,25 < C < 0,4	<b>P</b> C > 0,45%	<b>P</b> SCM	<b>M</b> INOX	<b>N</b> Al	<b>N</b> AC,ADC	<b>S</b> Ti	<b>H</b> 25-35 HRC	m/min
15-60	15-60	10-60	8-30	8-20	15-35	15-35	5-10	8-20	

<b>A</b>	<b>BA (BS93)</b>	<b>PM</b>	<b>V</b>	<b>C/2,5</b>	
----------	------------------	-----------	----------	--------------	--

EDP	BA	L	l	l1	d	a	Z	Price
48139910	0	66	19	30	6,3	5	3	
48139911	1	62	17	26	5,6	4,5	3	
48139912	2	58	16	25	5	4	3	
48139913	3	53	13	21	4,5	3,55	2	
48139914	4	50	13	20	3,55	2,8	2	
48139915	5	48	11	18	3,15	2,5	2	
48139916	6	44,5	9,5	-	2,8	2,24	2	
48139917	7	44,5	9,5	-	2,8	2,24	2	
48139918	8	44,5	9,5	-	2,8	2,24	2	
48139919	9	41	8	-	2,5	2	2	
48139920	10	41	8	-	2,5	2	2	
48139921	11	41	8	-	2,5	2	2	
48139922	12	40	7	-	2,5	2	2	

Threading | Cutting taps



BA

# A-TPT

Threading | Cutting taps | RC (BSPT)

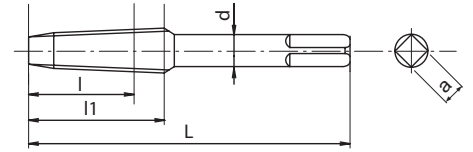

- First choice in quality and performance
- Powder metal straight flute cutting tap for through & blind holes
- Multilayer TiCN coating
- High speed tapping in general steels and aluminium
- RC (BSPT) tapered 1:16

Threading | Cutting taps

<b>P</b>	<b>P</b>	<b>P</b>	<b>P</b>	<b>N</b>	<b>N</b>	
C < 0,2%	0,25 < C < 0,4	C > 0,45%	SCM	Al	AC,ADC	
5-10	5-10	5-10	5-10	5-10	10-15	m/min

<b>A</b>	<b>Rc (PT)</b>	<b>PM</b>	<b>V</b>	<b>C/2,5</b>	<b>DIN 5156</b>
----------	----------------	-----------	----------	--------------	-----------------

RC (BSPT)

EDP	RC	P	L	l1	d	a	Z	DIN	Price
48212384	1/8	28	90	12	7	5,5	4	DIN5156	
48212394	1/4	19	100	18	11	9	4	DIN5156	
48212404	3/8	19	110	18	12	9	4	DIN5156	
48212414	1/2	14	125	23	16	12	4	DIN5156	
48212434	3/4	14	140	24	20	16	4	DIN5156	
48212454	1	11	160	30	25	20	4	DIN5156	



# A-POT NEW SIZES

Threading | Cutting taps | Metric



Type 1

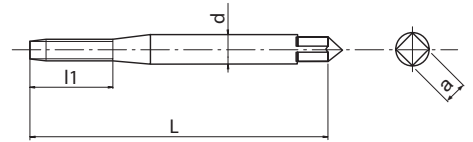

Type 2

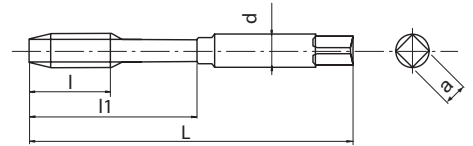

Type 3

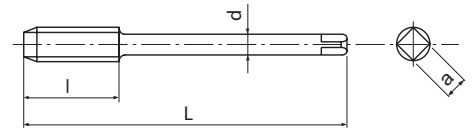

- First choice in quality and performance
- Powder metal spiral-point cutting tap for through holes
- Multilayer TiCN coating
- High speed tapping in general steels, aluminium, stainless steels

Threading | Cutting taps

<b>P</b> C < 0,2%	<b>P</b> 0,25 < C < 0,4	<b>P</b> C > 0,45%	<b>P</b> SCM	<b>M</b> INOX	<b>N</b> Al	<b>N</b> AC,ADC	<b>S</b> Ti	<b>H</b> 25-35 HRC	m/min
15-60	15-60	10-60	8-30	8-20	15-35	15-35	5-10	8-20	

<b>A</b>	<b>M</b>	<b>PM</b>	<b>V</b>	<b>ISO 2 6HX</b>	<b>B/4</b>	<b>DIN 371</b>	<b>DIN 376</b>
----------	----------	-----------	----------	------------------	------------	----------------	----------------

\* Tolerance 5HX

Metric

EDP	M	P	L	l	l1	d	a	Z	Type	DIN	Price
*48145111 <sup>NEW</sup>	1	0,25	40	-	5	2,5	2,1	2	1	DIN371	
*48145112 <sup>NEW</sup>	1,1	0,25	40	-	5	2,5	2,1	2	1	DIN371	
*48145113 <sup>NEW</sup>	1,2	0,25	40	-	5	2,5	2,1	2	1	DIN371	
*48145115	1,4	0,3	40	-	7	2,5	2,1	2	1	DIN371	
48145118	1,6	0,35	40	-	8	2,5	2,1	2	1	DIN371	
48145119	1,7	0,35	40	-	8	2,5	2,1	2	1	DIN371	
48145120	1,8	0,35	40	-	8	2,5	2,1	2	1	DIN371	
48145125	2	0,4	45	-	8	2,8	2,1	2	1	DIN371	
48145127	2,2	0,45	45	-	9	2,8	2,1	2	1	DIN371	
48145128	2,3	0,4	45	-	9	2,8	2,1	2	1	DIN371	
48145133	2,5	0,45	50	-	9	2,8	2,1	2	1	DIN371	
48145136	2,6	0,45	50	-	9	2,8	2,1	2	1	DIN371	
48145138	3	0,5	56	11	18	3,5	2,7	3	2	DIN371	
48145142	3,5	0,6	56	12	20	4	3	3	2	DIN371	
48145144	4	0,7	63	13	21	4,5	3,4	3	2	DIN371	
48145147	4,5	0,75	70	16	25	6	4,9	3	2	DIN371	
48145149	5	0,8	70	16	25	6	4,9	3	2	DIN371	
48145152	5,5	0,9	80	17	30	6	4,9	3	2	DIN371	
48145155	6	1	80	19	30	6	4,9	3	2	DIN371	
48145158	7	1	80	19	30	7	5,5	3	2	DIN371	
48145161	8	1,25	90	22	35	8	6,2	3	2	DIN371	
48145165	9	1,25	90	22	35	9	7	3	2	DIN371	
48145169	10	1,5	100	24	39	10	8	3	2	DIN371	
48145139	3	0,5	56	11	-	2,2	-	3	3	DIN376	
48145185	4	0,7	63	13	-	2,8	2,1	3	3	DIN376	
48145150	5	0,8	70	16	-	3,5	2,7	3	3	DIN376	
48145187	6	1	80	19	-	4,5	3,4	3	3	DIN376	
48145159	7	1	80	19	-	5,5	4,3	3	3	DIN376	
48145188	8	1,25	90	22	-	6	4,9	3	3	DIN376	
48145166	9	1,25	90	22	-	7	5,5	3	3	DIN376	
48145189	10	1,5	100	24	-	7	5,5	3	3	DIN376	
48145175	11	1,5	100	24	-	8	6,2	3	3	DIN376	
48145179	12	1,75	110	28	-	9	7	3	3	DIN376	
48145191	14	2	110	30	-	11	9	3	3	DIN376	
48145202	16	2	110	32	-	12	9	3	3	DIN376	
48145214	18	2,5	125	34	-	14	11	3	3	DIN376	
48145228	20	2,5	140	34	-	16	12	3	3	DIN376	
48145238	22	2,5	140	34	-	18	14,5	3	3	DIN376	
48145247	24	3	160	38	-	18	14,5	3	3	DIN376	

# A-OIL-POT

Threading | Cutting taps | Metric

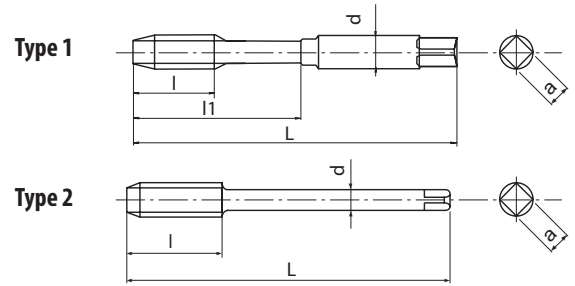

- First choice in quality and performance
- Powder metal spiral-point cutting tap for through holes
- Multilayer TiCN coating
- High speed tapping in general steels, aluminium, stainless steels
- Side through coolant

<b>P</b> C < 0,2%	<b>P</b> 0,25 < C < 0,4	<b>P</b> C > 0,45%	<b>P</b> SCM	<b>M</b> INOX	<b>N</b> Al	<b>N</b> AC,ADC	<b>S</b> Ti	<b>H</b> 25-35 HRC	
15-60	15-60	10-60	8-30	8-20	15-35	15-35	5-10	8-20	m/min

<b>A</b>	<b>M</b>	<b>PM</b>	<b>V</b>	<b>ISO 2 6HX</b>	<b>B/4</b>			<b>DIN 371</b>	<b>DIN 376</b>
----------	----------	-----------	----------	------------------	------------	--	--	----------------	----------------

EDP	M	P	L	l	l1	d	a	Z	Type	DIN	Price
48214155	6	1	80	19	30	6	4,9	3	1	DIN371	
48214161	8	1,25	90	22	35	8	6,2	3	1	DIN371	
48214169	10	1,5	100	24	39	10	8	3	1	DIN371	
48214179	12	1,75	110	28	-	9	7	3	2	DIN376	
48214191	14	2	110	30	-	11	9	3	2	DIN376	
48214202	16	2	110	32	-	12	9	3	2	DIN376	
48214214	18	2,5	125	34	-	14	11	3	2	DIN376	
48214228	20	2,5	140	34	-	16	12	3	2	DIN376	
48214238	22	2,5	140	34	-	18	14,5	3	2	DIN376	
48214247	24	3	160	38	-	18	14,5	3	2	DIN376	

Threading | Cutting taps



Metric

# A-POT 6GX

Threading | Cutting taps | Metric

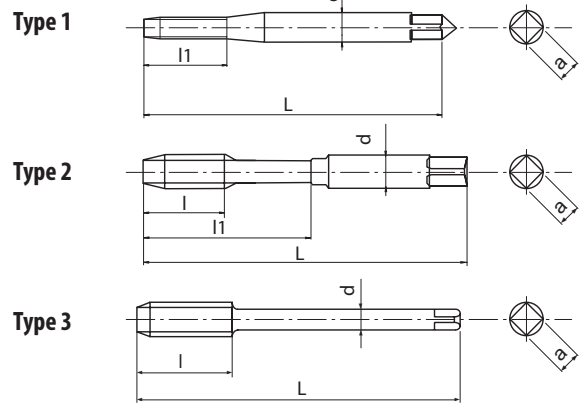
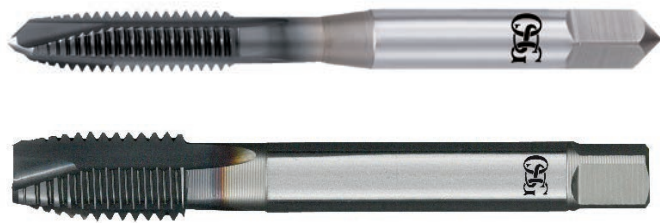

- First choice in quality and performance
- Powder metal spiral-point cutting tap for through holes
- Multilayer TiCN coating
- High speed tapping in general steels, aluminium, stainless steels
- For 6G internal thread tolerance

<b>P</b> C < 0,2%	<b>P</b> 0,25 < C < 0,4	<b>P</b> C > 0,45%	<b>P</b> SCM	<b>M</b> INOX	<b>N</b> Al	<b>N</b> AC,ADC	<b>S</b> Ti	<b>H</b> 25-35 HRC	
15-60	15-60	10-60	8-30	8-20	15-35	15-35	5-10	8-20	m/min

<b>A</b>	<b>M</b>	<b>PM</b>	<b>V</b>	<b>ISO 3 6GX</b>	<b>B/4</b>	<b>DIN 371</b>	<b>DIN 376</b>
----------	----------	-----------	----------	------------------	------------	----------------	----------------

EDP	M	P	oversize	L	l	l1	d	a	Z	Type	DIN	Price
48205125	2	0,4	+0,019	45	-	8	2,8	2,1	2	1	DIN371	
48205133	2,5	0,45	+0,020	50	-	9	2,8	2,1	2	1	DIN371	
48205138	3	0,5	+0,020	56	11	18	3,5	2,7	3	2	DIN371	
48205144	4	0,7	+0,022	63	13	21	4,5	3,4	3	2	DIN371	
48205149	5	0,8	+0,024	70	16	25	6	4,9	3	2	DIN371	
48205155	6	1	+0,026	80	19	30	6	4,9	3	2	DIN371	
48205161	8	1,25	+0,028	90	22	35	8	6,2	3	2	DIN371	
48205169	10	1,5	+0,032	100	24	39	10	8	3	2	DIN371	
48205179	12	1,75	+0,034	110	28	-	9	7	3	3	DIN376	
48205202	16	2	+0,038	110	32	-	12	9	3	3	DIN376	

Threading | Cutting taps

Metric



# A-POT+0.1

Threading | Cutting taps | Metric

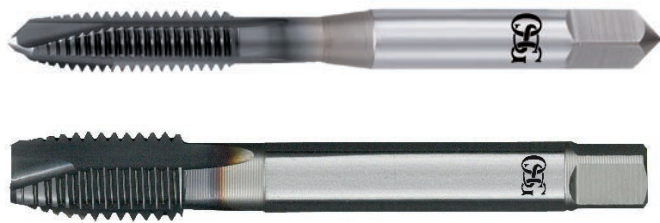

Type 1

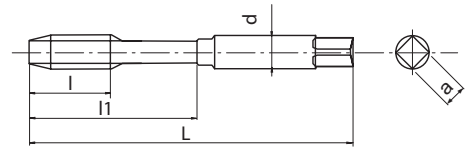

Type 2

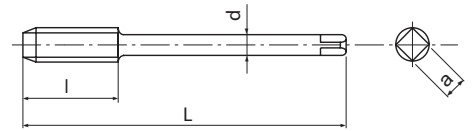

- First choice in quality and performance
- Powder metal spiral-point cutting tap for through holes
- Multilayer TiCN coating
- High speed tapping in general steels, aluminium, stainless steels
- Oversized tap for 6H +0,1mm thread tolerance

Threading | Cutting taps

<b>P</b> C < 0,2%	<b>P</b> 0,25 < C < 0,4	<b>P</b> C > 0,45%	<b>P</b> SCM	<b>M</b> INOX	<b>N</b> Al	<b>N</b> AC,ADC	<b>S</b> Ti	<b>H</b> 25-35 HRC	
15-60	15-60	10-60	8-30	8-20	15-35	15-35	5-10	8-20	m/min

<b>A</b>	<b>M</b>	<b>PM</b>	<b>V</b>	<b>6H +0.1</b>	<b>B/4</b>	<b>DIN 371</b>	<b>DIN 376</b>
----------	----------	-----------	----------	----------------	------------	----------------	----------------

EDP	M	P	L	l	l1	d	a	Z	Type	DIN	Price
48259138	3	0,5	56	11	18	3,5	2,7	3	1	DIN371	
48259144	4	0,7	63	13	21	4,5	3,4	3	1	DIN371	
48259149	5	0,8	70	16	25	6	4,9	3	1	DIN371	
48259155	6	1	80	19	30	6	4,9	3	1	DIN371	
48259161	8	1,25	90	22	35	8	6,2	3	1	DIN371	
48259169	10	1,5	100	24	39	10	8	3	1	DIN371	
48259179	12	1,75	110	28	-	9	7	3	2	DIN376	
48259202	16	2	110	32	-	12	9	3	2	DIN376	

Metric



# A-LT-POT

Threading | Cutting taps | Metric

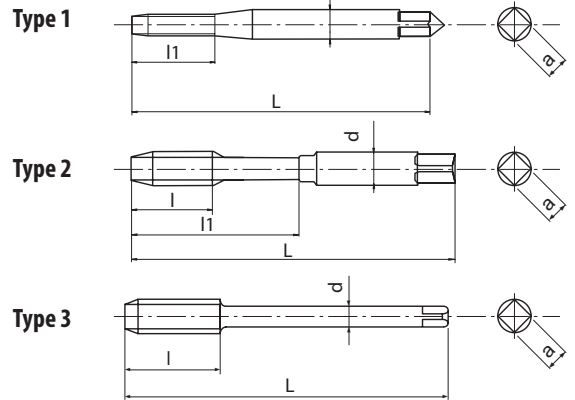

- First choice in quality and performance
- Powder metal spiral-point cutting tap for through holes
- Multilayer TiCN coating
- High speed tapping in general steels, aluminium, stainless steels
- With long shank for long reach threading

<b>P</b> C < 0,2%	<b>P</b> 0,25 < C < 0,4	<b>P</b> C > 0,45%	<b>P</b> SCM	<b>M</b> INOX	<b>N</b> Al	<b>N</b> AC,ADC	<b>S</b> Ti	<b>H</b> 25-35 HRC	m/min
15-60	15-60	10-60	8-30	8-20	15-35	15-35	5-10	8-20	

<b>A</b>	<b>M</b>	<b>PM</b>	<b>V</b>	<b>ISO 2 6HX</b>	<b>B/4</b>	<b>DIN 371</b>	<b>DIN 376</b>
----------	----------	-----------	----------	------------------	------------	----------------	----------------

EDP	M	P	L	l	l1	d	a	Z	Type	DIN	Price
48210125	2	0,4	80	8	-	2,8	2,1	2	1	DIN371	
48210133	2,5	0,45	100	9	-	2,8	2,1	2	1	DIN371	
48210138	3	0,5	100	11	18	3,5	2,7	3	2	DIN371	
48210144	4	0,7	125	13	21	4,5	3,4	3	2	DIN371	
48210149	5	0,8	160	16	25	6	4,9	3	2	DIN371	
48210155	6	1	160	19	30	6	4,9	3	2	DIN371	
48210161	8	1,25	180	22	35	8	6,2	3	2	DIN371	
48210169	10	1,5	200	24	39	10	8	3	2	DIN371	
48211155	6	1	160	19	-	4,5	3,4	3	3	DIN376	
48211161	8	1,25	180	22	-	6	4,9	3	3	DIN376	
48211169	10	1,5	200	24	-	7	5,5	3	3	DIN376	
48211179	12	1,75	200	28	-	9	7	3	3	DIN376	
48211191	14	2	200	30	-	11	9	3	3	DIN376	
48211202	16	2	200	32	-	12	9	3	3	DIN376	
48211214	18	2,5	200	34	-	14	11	3	3	DIN376	
48211228	20	2,5	200	34	-	16	12	3	3	DIN376	



# A-POT-LH

Threading | Cutting taps | Metric



Type 1

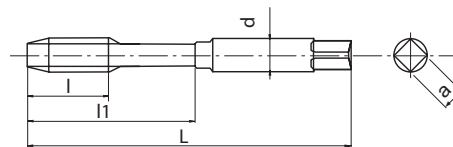

Type 2

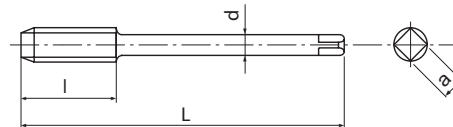

- First choice in quality and performance
- Powder metal spiral-point cutting tap for through holes
- Multilayer TiCN coating
- High speed tapping in general steels, aluminium, stainless steels
- For left-hand threads

Threading | Cutting taps

<b>P</b>	<b>P</b>	<b>P</b>	<b>P</b>	<b>M</b>	<b>N</b>	<b>N</b>	<b>S</b>	<b>H</b>	m/min
C < 0,2%	0,25 < C < 0,4	C > 0,45%	SCM	INOX	Al	AC,ADC	Ti	25-35 HRC	
15-60	15-60	10-60	8-30	8-20	15-35	15-35	5-10	8-20	

<b>A</b>	<b>M</b>	<b>PM</b>	<b>V</b>	<b>ISO 2 6HX</b>	<b>B/4</b>	<b>DIN 371</b>	<b>DIN 376</b>	<b>LH</b>
----------	----------	-----------	----------	------------------	------------	----------------	----------------	-----------

EDP	M	P	L	l	l1	d	a	Z	Type	DIN	Price
48218138	3	0,5	56	11	18	3,5	2,7	3	1	DIN371	
48218144	4	0,7	63	13	21	4,5	3,4	3	1	DIN371	
48218149	5	0,8	70	16	25	6	4,9	3	1	DIN371	
48218155	6	1	80	19	30	6	4,9	3	1	DIN371	
48218161	8	1,25	90	22	35	8	6,2	3	1	DIN371	
48218169	10	1,5	100	24	39	10	8	3	1	DIN371	
48218179	12	1,75	110	28	-	9	7	3	2	DIN376	
48218191	14	2	110	30	-	11	9	3	2	DIN376	
48218202	16	2	110	32	-	12	9	3	2	DIN376	
48218214	18	2,5	125	34	-	14	11	3	2	DIN376	
48218228	20	2,5	140	34	-	16	12	3	2	DIN376	
48218238	22	2,5	140	34	-	18	14,5	3	2	DIN376	
48218247	24	3	160	38	-	18	14,5	3	2	DIN376	



Metric



# A-POT

Threading | Cutting taps | Metric Fine

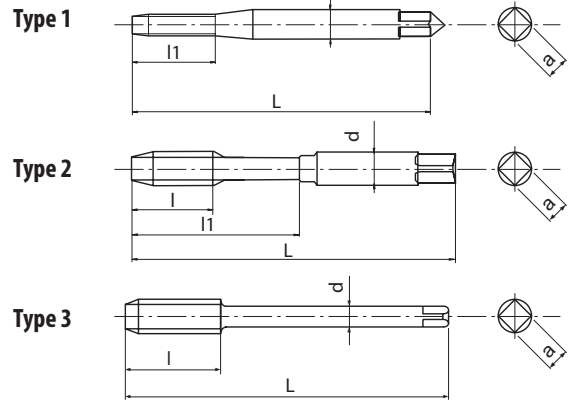

- First choice in quality and performance
- Powder metal spiral-point cutting tap for through holes
- Multilayer TiCN coating
- High speed tapping in general steels, aluminium, stainless steels

Threading | Cutting taps

<b>P</b> C < 0,2%	<b>P</b> 0,25 < C < 0,4	<b>P</b> C > 0,45%	<b>P</b> SCM	<b>M</b> INOX	<b>N</b> Al	<b>N</b> AC,ADC	<b>S</b> Ti	<b>H</b> 25-35 HRC	m/min
15-60	15-60	10-60	8-30	8-20	15-35	15-35	5-10	8-20	

<b>A</b>	<b>MF</b>	<b>PM</b>	<b>V</b>	<b>ISO 2 6HX</b>	<b>B/4</b>	<b>DIN 371</b>	<b>DIN 374</b>
----------	-----------	-----------	----------	------------------	------------	----------------	----------------

Metric Fine

EDP	MF	P	L	l	l1	d	a	Z	Type	DIN	Price
48145135	2,5	0,35	50	-	9	2,8	2,1	2	1	DIN371	
48145137	2,6	0,35	50	-	9	2,8	2,1	2	1	DIN371	
48145141	3	0,35	56	8	18	3,5	2,7	3	2	DIN371	
48145143	3,5	0,35	56	9	20	4	3	3	2	DIN371	
48145145	4	0,5	63	10	21	4,5	3,4	3	2	DIN371	
48145146	4	0,35	63	10	21	4,5	3,4	3	2	DIN371	
48145148	4,5	0,5	70	12	25	6	4,9	3	2	DIN371	
48145151	5	0,5	70	12	25	6	4,9	3	2	DIN371	
48145601	6	0,75	80	14	30	6	4,9	3	2	DIN371	
48145602	6	0,5	80	14	30	6	4,9	3	2	DIN371	
48145160	7	0,75	80	14	30	7	5,5	3	2	DIN371	
48145603	8	1	90	22	35	8	6,2	3	2	DIN371	
48145604	8	0,75	80	18	30	8	6,2	3	2	DIN371	
48145605	9	1	90	22	35	9	7	3	2	DIN371	
48145606	10	1,25	100	24	39	10	8	3	2	DIN371	
48145607	10	1	90	20	35	10	8	3	2	DIN371	
48145608	10	0,75	90	20	35	10	8	3	2	DIN371	
48145156	6	0,75	80	14	-	4,5	3,4	3	3	DIN374	
48145157	6	0,5	80	14	-	4,5	3,4	3	3	DIN374	
48145162	8	1	90	22	-	6	4,9	3	3	DIN374	
48145163	8	0,75	80	18	-	6	4,9	3	3	DIN374	
48145167	9	1	90	22	-	7	5,5	3	3	DIN374	
48145170	10	1,25	100	24	-	7	5,5	3	3	DIN374	
48145171	10	1	90	20	-	7	5,5	3	3	DIN374	
48145172	10	0,75	90	20	-	7	5,5	3	3	DIN374	
48145176	11	1	90	20	-	8	6,2	3	3	DIN374	
48145180	12	1,5	100	22	-	9	7	3	3	DIN374	
48145181	12	1,25	100	22	-	9	7	3	3	DIN374	
48145182	12	1	100	22	-	9	7	3	3	DIN374	
48145192	14	1,5	100	22	-	11	9	4	3	DIN374	
48145193	14	1,25	100	22	-	11	9	4	3	DIN374	
48145194	14	1	100	22	-	11	9	4	3	DIN374	
48145203	16	1,5	100	22	-	12	9	4	3	DIN374	
48145204	16	1	100	22	-	12	9	4	3	DIN374	
48145216	18	1,5	110	25	-	14	11	4	3	DIN374	
48145218	18	1	110	25	-	14	11	4	3	DIN374	
48145220	20	2	140	34	-	16	12	4	3	DIN374	
48145230	20	1,5	125	25	-	16	12	4	3	DIN374	
48145232	20	1	125	25	-	16	12	4	3	DIN374	
48145239	22	2	140	34	-	18	14,5	4	3	DIN374	
48145240	22	1,5	125	25	-	18	14,5	4	3	DIN374	
48145241	22	1	125	25	-	18	14,5	4	3	DIN374	
48145249	24	2	140	28	-	18	14,5	4	3	DIN374	
48145250	24	1,5	140	28	-	18	14,5	4	3	DIN374	
48145251	24	1	140	28	-	18	14,5	4	3	DIN374	

# A-OIL-POT

Threading | Cutting taps | Metric Fine

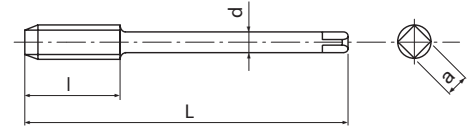

- First choice in quality and performance
- Powder metal spiral-point cutting tap for through holes
- Multilayer TiCN coating
- High speed tapping in general steels, aluminium, stainless steels
- Side through coolant

<b>P</b>	<b>P</b>	<b>P</b>	<b>P</b>	<b>M</b>	<b>N</b>	<b>N</b>	<b>S</b>	<b>H</b>		
15-60	15-60	10-60	8-30	8-20	15-35	15-35	5-10	8-20	m/min	



EDP	MF	P	L	l	d	a	Z	DIN	Price
48214162	8	1	90	22	6	4,9	3	DIN374	
48214171	10	1	90	20	7	5,5	3	DIN374	
48214170	10	1,25	100	24	7	5,5	3	DIN374	
48214180	12	1,5	100	22	9	7	3	DIN374	
48214192	14	1,5	100	22	11	9	4	DIN374	
48214203	16	1,5	100	22	12	9	4	DIN374	
48214216	18	1,5	110	25	14	11	4	DIN374	
48214230	20	1,5	125	25	16	12	4	DIN374	

Threading | Cutting taps

Metric Fine



# A-POT

Threading | Cutting taps | UNC

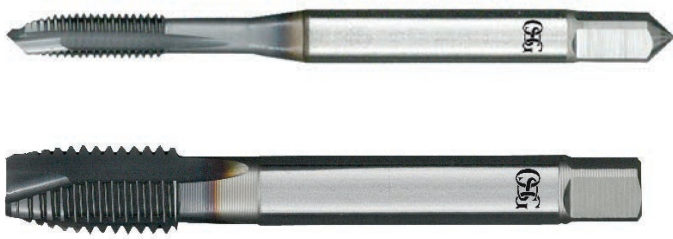

Type 1

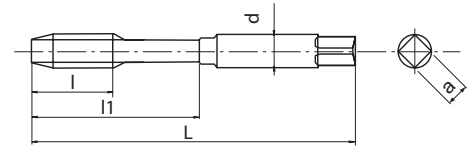

Type 2

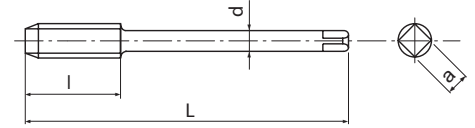

- First choice in quality and performance
- Powder metal spiral-point cutting tap for through holes
- Multilayer TiCN coating
- High speed tapping in general steels, aluminium, stainless steels

<b>P</b> C < 0,2%	<b>P</b> 0,25 < C < 0,4	<b>P</b> C > 0,45%	<b>P</b> SCM	<b>M</b> INOX	<b>N</b> Al	<b>N</b> AC,ADC	<b>S</b> Ti	<b>H</b> 25-35 HRC	
15-60	15-60	10-60	8-30	8-20	15-35	15-35	5-10	8-20	m/min

<b>A</b>	<b>UNC</b>	<b>PM</b>	<b>V</b>	<b>ANSI 2BX</b>	<b>B/4</b>	<b>DIN 2184-1</b>	<b>DIN 2184-1</b>
----------	------------	-----------	----------	-----------------	------------	-------------------	-------------------

EDP	UNC	P	L	l	l1	d	a	Z	Type	DIN	Price
48145453	2	56	45	-	9	2,8	2,1	2	1	DIN2184-1	
48145455	3	48	50	-	9	2,8	2,1	2	1	DIN2184-1	
48145457	4	40	56	11	18	3,5	2,7	2	1	DIN2184-1	
48145459	5	40	56	11	18	3,5	2,7	3	1	DIN2184-1	
48145461	6	32	56	12	20	4	3	3	1	DIN2184-1	
48145464	8	32	63	13	21	4,5	3,4	3	1	DIN2184-1	
48145466	10	24	70	16	25	6	4,9	3	1	DIN2184-1	
48145468	12	24	80	17	30	6	4,9	3	1	DIN2184-1	
48145471	1/4	20	80	19	30	7	5,5	3	1	DIN2184-1	
48145474	5/16	18	90	22	35	8	6,2	3	1	DIN2184-1	
48145479	3/8	16	100	24	39	10	8	3	1	DIN2184-1	
48145484	7/16	14	100	24	-	8	6,2	3	2	DIN2184-1	
48145489	1/2	13	110	28	-	9	7	3	2	DIN2184-1	
48145494	9/16	12	110	30	-	11	9	3	2	DIN2184-1	
48145501	5/8	11	110	32	-	12	9	3	2	DIN2184-1	
48145515	3/4	10	125	34	-	14	11	3	2	DIN2184-1	
48145526	7/8	9	140	34	-	18	14,5	3	2	DIN2184-1	
48145538	1	8	160	38	-	18	14,5	3	2	DIN2184-1	



# A-POT

Threading | Cutting taps | UNF

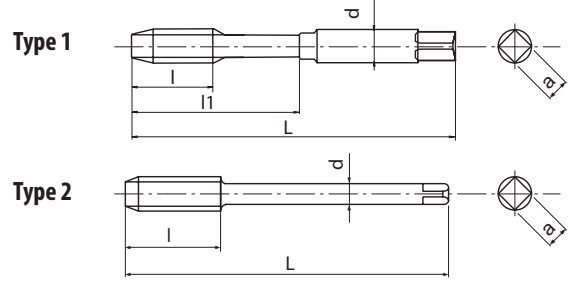
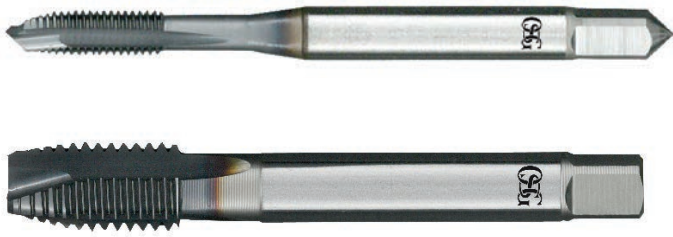

- First choice in quality and performance
- Powder metal spiral-point cutting tap for through holes
- Multilayer TiCN coating
- High speed tapping in general steels, aluminium, stainless steels

Threading | Cutting taps

<b>P</b> C < 0,2%	<b>P</b> 0,25 < C < 0,4	<b>P</b> C > 0,45%	<b>P</b> SCM	<b>M</b> INOX	<b>N</b> Al	<b>N</b> AC,ADC	<b>S</b> Ti	<b>H</b> 25-35 HRC	<b>m/min</b>
15-60	15-60	10-60	8-30	8-20	15-35	15-35	5-10	8-20	

<b>A</b>	<b>UNF</b>	<b>PM</b>	<b>V</b>	<b>ANSI 2BX</b>	<b>B/4</b>		<b>DIN 2184-1</b>	<b>DIN 2184-1</b>
----------	------------	-----------	----------	-----------------	------------	--	-------------------	-------------------

UNF

EDP	UNF	P	L	l	l1	d	a	Z	Type	DIN	Price
48145454	2	64	45	-	9	2,8	2,1	2	1	DIN2184-1	
48145456	3	56	50	-	9	2,8	2,1	2	1	DIN2184-1	
48145458	4	48	56	11	18	3,5	2,7	2	1	DIN2184-1	
48145460	5	44	56	11	18	3,5	2,7	3	1	DIN2184-1	
48145462	6	40	56	12	20	4	3	3	1	DIN2184-1	
48145465	8	36	63	13	21	4,5	3,4	3	1	DIN2184-1	
48145467	10	32	70	16	25	6	4,9	3	1	DIN2184-1	
48145469	12	28	80	17	30	6	4,9	3	1	DIN2184-1	
48145472	1/4	28	80	19	30	7	5,5	3	1	DIN2184-1	
48145476	5/16	24	90	22	35	8	6,2	3	1	DIN2184-1	
48145481	3/8	24	90	20	35	10	8	3	1	DIN2184-1	
48145486	7/16	20	100	24	-	8	6,2	3	2	DIN2184-1	
48145491	1/2	20	100	22	-	9	7	3	2	DIN2184-1	
48145496	9/16	18	100	22	-	11	9	3	2	DIN2184-1	
48145504	5/8	18	100	22	-	12	9	3	2	DIN2184-1	
48145517	3/4	16	110	25	-	14	11	3	2	DIN2184-1	
48145528	7/8	14	125	25	-	18	14,5	3	2	DIN2184-1	
48145539	1	12	140	28	-	18	14,5	3	2	DIN2184-1	



# A-POT

## Threading | Cutting taps | G (BSP)

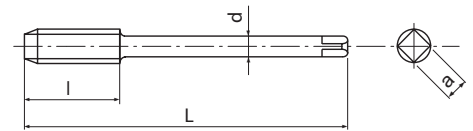

- First choice in quality and performance
- Powder metal spiral-point cutting tap for through holes
- Multilayer TiCN coating
- High speed tapping in general steels, aluminium, stainless steels

<b>P</b> ●	<b>P</b> ●	<b>P</b> ●	<b>P</b> ●	<b>M</b> ●	<b>N</b> ○	<b>N</b> ○	<b>S</b> ○	<b>H</b> ○	
C < 0,2%	0,25 < C < 0,4	C > 0,45%	SCM	INOX	Al	AC, ADC	Ti	25-35 HRC	
15-60	15-60	10-60	8-30	8-20	15-35	15-35	5-10	8-20	m/min

**A**
**G**
**PM**
**V**
**B/4**
**DIN 5156**

EDP	G	P	L	l	d	a	Z	DIN	Price
48145900	1/8	28	90	20	7	5,5	3	DIN5156	
48145000	1/4	19	100	22	11	9	3	DIN5156	
48145100	3/8	19	100	22	12	9	3	DIN5156	
48145200	1/2	14	125	25	16	12	3	DIN5156	
48145300	5/8	14	125	25	18	14,5	4	DIN5156	
48145400	3/4	14	140	28	20	16	4	DIN5156	
48145500	7/8	14	150	28	22	18	4	DIN5156	
48145600	1	11	160	30	25	20	4	DIN5156	



# A-POT

Threading | Cutting taps | BSW

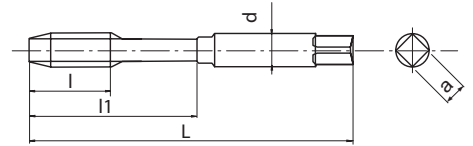

- First choice in quality and performance
- Powder metal spiral-point cutting tap for through holes
- Multilayer TiCN coating
- High speed tapping in general steels, aluminium, stainless steels

Threading | Cutting taps

<b>P</b> C < 0,2%	<b>P</b> 0,25 < C < 0,4	<b>P</b> C > 0,45%	<b>P</b> SCM	<b>M</b> INOX	<b>N</b> Al	<b>N</b> AC, ADC	<b>S</b> Ti	<b>H</b> 25-35 HRC	
15-60	15-60	10-60	8-30	8-20	15-35	15-35	5-10	8-20	m/min

<b>A</b>	<b>BSW</b>	<b>PM</b>	<b>V</b>	<b>MED</b>	<b>B/4</b>	<b>DIN 2184-1</b>
----------	------------	-----------	----------	------------	------------	-------------------

BSW

EDP	BSW	TPI	L	l	l1	d	a	Z	DIN	Price
48205702	1/8	40	56	11	18	3,5	2,7	3	DIN2184-1	
48205704	3/16	24	70	16	25	6	4,9	3	DIN2184-1	
48205706	1/4	20	80	19	30	7	5,5	3	DIN2184-1	
48205707	5/16	18	90	22	35	8	6,2	3	DIN2184-1	
48205708	3/8	16	100	24	39	10	8	3	DIN2184-1	
48205709	7/16	14	100	24	-	8	6,2	3	DIN2184-1	
48205710	1/2	12	110	28	-	9	7	3	DIN2184-1	
48205712	5/8	11	110	32	-	12	9	3	DIN2184-1	
48205713	3/4	10	125	34	-	14	11	3	DIN2184-1	
48205714	7/8	9	140	34	-	18	14,5	3	DIN2184-1	
48205715	1	8	160	38	-	18	14,5	3	DIN2184-1	



# A-POT

## Threading | Cutting taps | BA

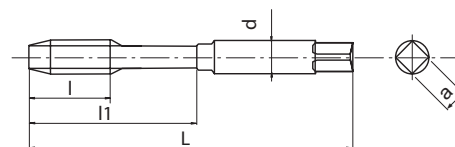

- First choice in quality and performance
- Powder metal spiral-point cutting tap for through holes
- Multilayer TiCN coating
- High speed tapping in general steels, aluminium, stainless steels

<b>P</b> C < 0,2%	<b>P</b> 0,25 < C < 0,4	<b>P</b> C > 0,45%	<b>P</b> SCM	<b>M</b> INOX	<b>N</b> Al	<b>N</b> AC,ADC	<b>S</b> Ti	<b>H</b> 25-35 HRC	
15-60	15-60	10-60	8-30	8-20	15-35	15-35	5-10	8-20	m/min



EDP	BA	L	l	l1	d	a	Z	Price
48205910	0	66	19	30	6,3	5	3	
48205911	1	62	17	26	5,6	4,5	3	
48205912	2	58	16	25	5	4	3	
48205913	3	53	13	21	4,5	3,55	3	
48205914	4	50	13	20	3,55	2,8	3	
48205915	5	48	11	18	3,15	2,5	3	
48205916	6	44,5	9,5	-	2,8	2,24	2	
48205917	7	44,5	9,5	-	2,8	2,24	2	
48205918	8	44,5	9,5	-	2,8	2,24	2	
48205919	9	41	8	-	2,5	2	2	
48205920	10	41	8	-	2,5	2	2	
48205921	11	41	8	-	2,5	2	2	
48205922	12	40	7	-	2,5	2	2	

Threading | Cutting taps





[www.osgeurope.com](http://www.osgeurope.com)



## SWEDEN

Branch office of OSG SCANDINAVIA  
Abrahams Gränd 8  
295 35 Bromölla  
Sweden  
Tel: +46 40 41 22 55  
Fax: +46 40 41 32 55  
osg@osg-scandinavia.com

## OSG SCANDINAVIA

(For Scandinavian countries)  
Langebjergvaenget 16  
4000 Roskilde  
Denmark  
Tel.: +45 46 75 65 55  
Fax: +45 46 75 67 00  
osg@osg-scandinavia.com

## OSG NETHERLANDS

Bedrijfsweg 5 - 3481 MG Harmelen  
Postbus 50 - 3480 DB Harmelen  
The Netherlands  
Tel.: +31 348 44 2764  
Fax: +31 348 44 2144  
info@osg-nl.com

## OSG UK

Shelton house, 5 Bentalls  
Pipps Hill Ind Est, Basildon Essex SS14 3BY  
United Kingdom  
Tel.: +44 845 305 1066  
Fax: +44 845 305 1067  
sales@osg-uk.com

## OSG EUROPE LOGISTICS

Avenue Lavoisier 1  
B-1300 Z.I. Wavre - Nord  
Belgium  
Tel.: +32 10 23 05 07  
Fax: +32 10 23 05 11  
info@osgeurope.com

## OSG BELUX

Avenue Lavoisier 1  
B-1300 Z.I. Wavre - Nord  
Belgium  
Tel.: +32 10 23 05 11  
Fax: +32 10 23 05 31  
info@osg-belgium.com

## OSG IBERICA

Bekolarra 4  
E - 01010 Vitoria-Gasteiz  
Spain  
Tel.: +34 945 242 400  
Fax: +34 945 228 883  
osg.iberica@osg-ib.com

## OSG FRANCE

Parc Icade, Paris Nord 2  
Immeuble "Le Rimbaud"  
22 Avenue des Nations  
CS66191 - 93420 Villepinte  
France  
Tel.: +33 1 49 90 10 10  
Fax: +33 1 49 90 10 15  
sales@osg-france.com





#### SLOVAKIA

Branch office of OSG Belgium s.a.  
Tel: +32 10 23 05 04  
Fax: +32 10 23 05 31  
info@osg-belgium.com

#### OSG POLAND

Spółdzielcza 57  
05-074 Halinów  
Poland

#### OSG RUSSIA

Butlerova street, 17B, office 5069  
117342 Moscow  
Russia  
Tel: +7 (495) 150 41 54  
info@osg-russia.com

#### ROMSAN INTERNATIONAL CO. SRL

Reprezentant Exclusiv OSG  
23-25, Nerva Traian Street  
031044 Bucuresti  
România  
Tel: +40 021 322 07 47  
Fax: +40 021 321 56 00  
romsan.int@romsan.ro

#### OSG TURKEY

Rami Kişla Cad.No:56 Eyüp  
Istanbul 34056  
Turkey  
Tel:+90 212 565 24 00  
Fax: +90 212 565 44 00  
info@osg-turkey.com

#### OSG ITALIA

Via Cirenaiica n. 52 int. 61/63  
I - 10142 Torino  
Italy  
Tel.: +39 0117705211  
Fax: +39 0117071402  
info@osg-italia.it

#### OSG GERMANY

Karl-Ehmann-Str. 25  
D - 73037 Göppingen  
Germany  
Tel.: +49 7161 6064 - 0  
Fax: +49 7161 6064 - 444  
info@osg-germany.de



*shaping your dreams*

#### **OSG EUROPE LOGISTICS**

Avenue Lavoisier 1  
B-1300 Z.I. Wavre - Nord - Belgium  
Tel: +32 10 23 05 07  
Fax: +32 10 23 05 51  
info@osgeurope.com

#### **OSG BELUX**

Avenue Lavoisier 1  
B-1300 Z.I. Wavre - Nord - Belgium  
Tel: +32 10 23 05 11  
Fax: +32 10 23 05 31  
info@osg-belgium.com

#### **OSG FRANCE**

Parc Icade, Paris Nord 2  
Immeuble "Le Rimbaud"  
22 Avenue des Nations  
CS66191 - 93420 Villepinte - France  
Tel: +33 1 49 90 10 10  
Fax: +33 1 49 90 10 15  
sales@osg-france.com

#### **OSG NETHERLANDS**

Bedrijfsweg 5 - 3481 MG Harmelen  
Tel: +31 348 44 2764  
Fax: +31 348 44 2144  
info@osg-nl.com

#### **OSG UK**

Shelton house, 5 Bentalls  
Pipps Hill Ind Est, Basildon Essex SS14 3BY  
Tel: +44 845 305 1066  
Fax: +44 845 305 1067  
sales@osg-uk.com

#### **SLOVAKIA**

Branch office of OSG Europe Logistics s.a.  
Tel (SK) +421 2 4329 1295  
Tel (BE) +32 10 23 05 07  
Fax (BE) +32 10 23 05 51  
sales-osgsvk@osgeurope.com

#### **OSG POLAND Sp. z.o.o.**

Spółdzielcza 57  
05-074 Halinów - Poland  
Tel: +22 760 82 71  
Fax: +22 760 82 71  
osg@osg-poland.com

#### **OSG GERMANY**

Karl-Ehmann-Str. 25  
D - 73037 Göppingen - Germany  
Tel: +49 7161 6064 - 0  
Fax: +49 7161 6064 - 444  
info@osg-germany.de

#### **OSG SCANDINAVIA**

(For Scandinavian countries)  
Langebjergvaenget 16  
4000 Roskilde - Denmark  
Tel: +45 46 75 65 55  
Fax: +45 46 75 67 00  
osg@osg-scandinavia.com

#### **SWEDEN**

Branch office of OSG SCANDINAVIA  
Abrahams Gränd 8  
295 35 Bromölla - Sweden  
Tel: +46 40 41 22 55  
Fax: +46 40 41 32 55  
osg@osg-scandinavia.com

#### **OSG IBERICA**

Bekolarra 4  
E - 01010 Vitoria-Gasteiz - Spain  
Tel: +34 945 242 400  
Fax: +34 945 228 883  
osg.iberica@osg-ib.com

#### **RUSSIA**

Butlerova street, 17B, office 5069  
117342 Moscow - Russia  
Tel: +7 (495) 150 41 54  
info@osg-russia.com

#### **OSG TURKEY**

Rami Kişla Cad.No:56 Eyüp  
Istanbul 34056 - Turkey  
Tel:+90 212 565 24 00  
Fax: +90 212 565 44 00  
info@osg-turkey.com

#### **ROMSAN INTERNATIONAL CO. SRL**

Reprezentant Exclusiv OSG  
23-25, Nerva Traian Street  
031044 Bucuresti - România  
Tel: +40 021 322 07 47  
Fax: +40 021 321 56 00  
romsan.int@romsan.ro

#### **AUSTRIA**

Branch office of OSG GERMANY  
Messestraße 11  
A-6850 Dornbirn  
Tel: +49 7161 6064-0  
Fax: +49 7161 6064-444  
info@osg-germany.de

#### **OSG ITALIA**

Via Cirenaiica n. 52 int. 61/63  
I - 10142 Torino - Italy  
Tel: +39 0117705211  
Fax: +39 0117071402  
info@osg-italia.it

#### **Vischer & Bolli AG**

Im Schossacher 17  
CH-8600 Dübendorf  
Schweiz  
Tel.: +41 44 802 15 15  
Fax: +41 44 802 15 95  
info@vb-tools.com

#### **OSG EUROPE LOGISTICS S.A.**

04/2018 - All rights reserved. © OSG Europe 2018.

The contents of this catalogue are provided to you for viewing only. They are not intended for reproduction either in part or in whole in this or other medium. They cannot be copied, used to create derivation work or used for any reason, by means without the express, written permission of the copyright owner. If prices are stated, they are netto unit-prices and any eventual tax(es) have to be added. The company is not responsible for any printing error in technical, price and/or any other data.

Tool specifications subject to change without notice.

[www.osgeurope.com](http://www.osgeurope.com)

